

Other Precision CNC Machine Toolholders

Face Mill Arbors

*H6 arbor tolerance reduces chatter
CoolBLAST coolant capable (pg. 114)*



Milling Chucks

*New coolant option available
Outstanding rigidity and performance
(pg. 122)*



Morse Taper Holders

*Techniks Certified for
accuracy (pg. 125)*



Hydraulics

*3 micron T.I.R. for
optimal accuracy (pg. 126)*



SIMIS Tooling

*ER collet chucks and
endmill holders
(pg. 128)*



Drill Chucks

*Better accuracy and
holding power (pg. 130)*



Built for Speed.

CAT40 Precision Face Mill Arbors



Features

- Compatible with all coolant-thru face mills
- H6 arbor tolerance for less chatter and better tool life
- Each arbor lab certified for accuracy
- Taper ground to AT₃ tolerance or better



Arbor
Screws
pg. 121



Tightening
Stands
pg. 206



Retention
Knobs
pg. 200



Wrenches
pg. 204

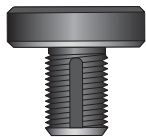

CoolBLAST arbor screw provides coolant path.
Order on page 121.

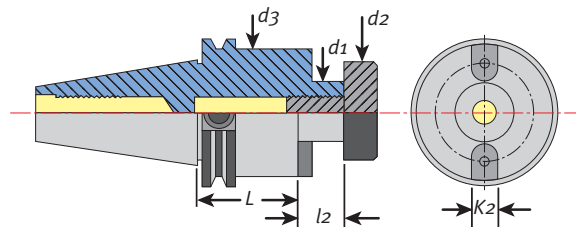

CAT40 Face Mill Arbors

Part No.	Description	L	l2	d1	d2	d3	K2
22709	CAT40 x FMA 1/2" - 1.37"	1.37"	.55"	1/2"	.66"	1.45"	.25"
22709-4	CAT40 x FMA 1/2" - 4"	4"	.55"	1/2"	.66"	1.45"	.25"
22711	CAT40 x FMA 3/4" - 1.37"	1.37"	.69"	3/4"	.88"	1.69"	.31"
22711-4	CAT40 x FMA 3/4" - 4.0"	4"	.69"	3/4"	.88"	1.69"	.31"
22711-6	CAT40 x FMA 3/4" - 6.0"	6"	.69"	3/4"	.88"	1.69"	.31"
22713	CAT40 x FMA 1.0" - 2.06"	2.06"	.69"	1.0"	1.19"	2.2"	.38"
22713-4	CAT40 x FMA 1.0" - 4.0"	4"	.69"	1.0"	1.19"	2.2"	.38"
22713-6	CAT40 x FMA 1.0" - 6.0"	6"	.69"	1.0"	1.19"	2.2"	.38"
22715	CAT40 x FMA 1-1/4" - 2.21"	2.21"	.69"	1-1/4"	1.5"	2.75"	.5"
22715-4	CAT40 x FMA 1-1/4" - 4.0"	4"	.69"	1-1/4"	1.5"	2.75"	.5"
22715-6	CAT40 x FMA 1-1/4" - 6.0"	6"	.69"	1-1/4"	1.5"	3."	.5"
22717	CAT40 x FMA 1-1/2" - 2.21"	2.21"	.94"	1-1/2"	1.88"	3.8"	.63"
22717-4	CAT40 x FMA 1-1/2" - 4"	4"	.94"	1-1/2"	1.88"	3.8"	.63"

CAT40 Precision DualDRIVE Face Mill Arbors



Features

- Compatible with all coolant-thru face mills
- H6 arbor tolerance for less chatter and better tool life
- Taper ground to AT3 tolerance or better
- Use with your existing dual contact spindles

Benefits

- Better rigidity and reduced vibration
- Improved performance at high metal removal rates and when machining at extended lengths
- Provides the benefits of dual-contact machining on standard spindles too!

See an on machine demonstration video of DualDRIVE compared to standard toolholders at: www.techniksusa.com/videos2008/DD

CoolBLAST Coolant Option

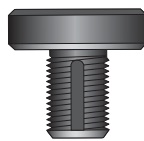

CoolBLAST arbor screw provides coolant path. Order on page 121.

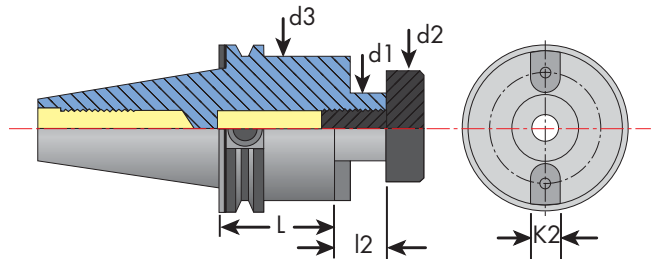
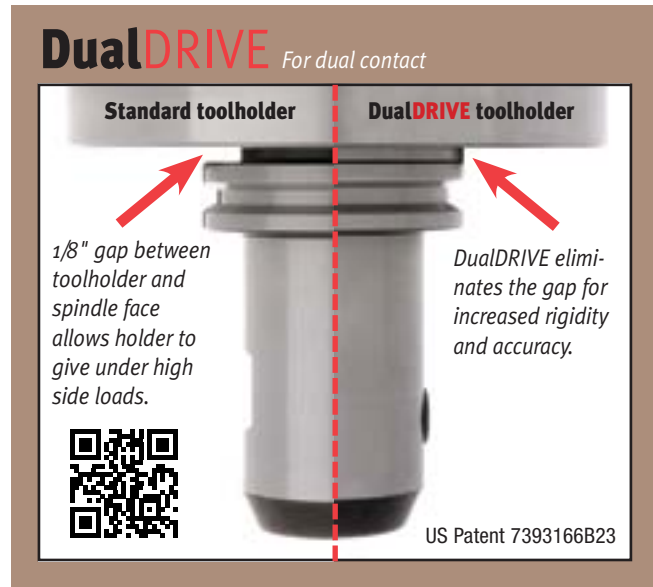

CAT40 DualDRIVE Face Mill Arbors

Part No.	Description	L	l2	d1	d2	d3	K2
72711	CAT40 x FMA 3/4" - 1.37" DualDRIVE	1.37"	.69"	3/4"	.88"	1.69"	.31"
72711-4	CAT40 x FMA 3/4" - 4" DualDRIVE	4"	.69"	3/4"	.88"	1.69"	.31"
72711-6	CAT40 x FMA 3/4" - 6" DualDRIVE	6"	.69"	3/4"	.88"	1.69"	.31"
72713	CAT40 x FMA 1.0" - 2.06" DualDRIVE	2.06"	.69"	1.0"	1.19"	2.2"	.38"
72713-4	CAT40 x FMA 1.0" - 4" DualDRIVE	4"	.69"	1.0"	1.19"	2.2"	.38"
72713-6	CAT40 x FMA 1.0" - 6" DualDRIVE	6"	.69"	1.0"	1.19"	2.2"	.38"
72715	CAT40 x FMA 1-1/4" - 2.21" DualDRIVE	2.21"	.69"	1-1/4"	1.5"	2.75"	.5"
72715-4	CAT40 x FMA 1-1/4" - 4" DualDRIVE	4"	.69"	1-1/4"	1.5"	2.75"	.5"
72715-6	CAT40 x FMA 1-1/4" - 6" DualDRIVE	6"	.69"	1-1/4"	1.5"	3"	.5"
72717	CAT40 x FMA 1-1/2" - 2.21" DualDRIVE	2.21"	.94"	1-1/2"	1.88"	3.8"	.63"
72717-4	CAT40 x FMA 1-1/2" - 4" DualDRIVE	4"	.94"	1-1/2"	1.88"	3.8"	.63"

CAT50 Precision Face Mill Arbors



Features

- Compatible with all coolant-thru face mills
- H6 arbor tolerance for less chatter and better tool life
- Each arbor lab certified for accuracy
- Taper ground to AT₃ tolerance or better



Arbor Screws
pg. 121



Tightening Stands
pg. 206



Retention Knobs
pg. 200



Wrenches
pg. 204

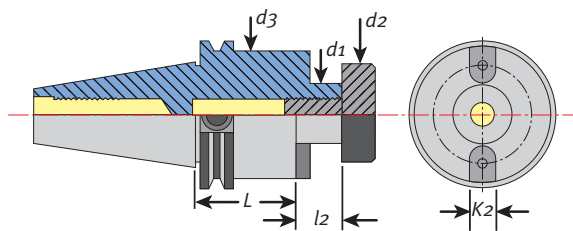

CAT50 Face Mill Arbors

Part No.	Description	L	l2	d1	d2	d3	K2
22719	CAT50 x FMA 1/2" - 1.5"	1.5"	.055"	1/2"	.66"	1.45"	.25"
22721	CAT50 x FMA 3/4" - 1.5"	1.5"	.69"	3/4"	.88"	2.75"	.31"
22721-3.5	CAT50 x FMA 3/4" - 3.5"	3.5"	.69"	3/4"	.88"	1.69"	.31"
22721-5.5	CAT50 x FMA 3/4" - 5.5"	5.5"	.69"	3/4"	.88"	1.69"	.31"
22721-8	CAT50 x FMA 3/4" - 8"	8"	.69"	3/4"	.88"	1.69"	.31"
22721-10	CAT50 x FMA 3/4" - 10"	10"	.69"	3/4"	.88"	1.69"	.31"
22723	CAT50 x FMA 1" - 2.0"	2.0"	.69"	1.0"	1.19"	2.2"	.38"
22723-4	CAT50 x FMA 1" - 4.0"	4"	.69"	1.0"	1.19"	2.2"	.38"
22723-6	CAT50 x FMA 1" - 6.0"	6"	.69"	1.0"	1.19"	2.2"	.38"
22723-8	CAT50 x FMA 1" - 8.0"	8"	.69"	1.0"	1.19"	2.2"	.38"
22723-10	CAT50 x FMA 1" - 10.0"	10"	.69"	1.0"	1.19"	2.2"	.38"
22725	CAT50 x FMA 1-1/4" - 1.50"	1.5"	.69"	1-1/4"	1.5"	2.75"	.5"
22725-3.5	CAT50 x FMA 1-1/4" - 3.5"	3.5"	.69"	1-1/4"	1.5"	2.75"	.5"
22725-6	CAT50 x FMA 1-1/4" - 6.0"	6"	.69"	1-1/4"	1.5"	2.75"	.5"
22725-8	CAT50 x FMA 1-1/4" - 8.0"	8"	.69"	1-1/4"	1.5"	2.75"	.5"
22727	CAT50 x FMA 1-1/2" - 2.4"	2.4"	.94"	1-1/2"	1.88"	3.8"	.63"
22727-4	CAT50 x FMA 1-1/2" - 4.0"	4"	.94"	1-1/2"	1.88"	3.8"	.63"
22727-6	CAT50 x FMA 1-1/2" - 6.0"	6"	.94"	1-1/2"	1.88"	3.8"	.63"
22727-8	CAT50 x FMA 1-1/2" - 8.0"	8"	.94"	1-1/2"	1.88"	3.8"	.63"
22729	CAT50 x FMA 2" - 2.4"	2.4"	.94"	2"	2.5"	4.88"	.75"
22729-4	CAT50 x FMA 2" - 4.0"	4"	.94"	2"	2.5"	4.88"	.75"

CoolBLAST Coolant Option

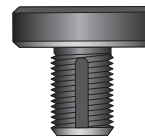

CoolBLAST arbor screw provides coolant path.
Order on page 121.

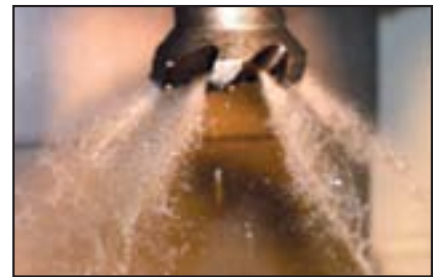

CAT50 Precision DualDRIVE Face Mill Arbors

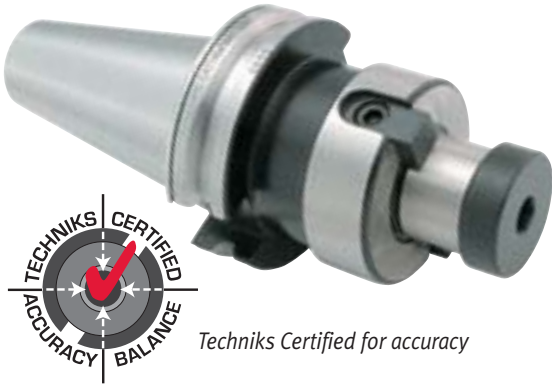

Techniks Certified for accuracy

Benefits

- Better rigidity and reduced vibration
- Improved performance at high metal removal rates and when machining at extended lengths
- Provides the benefits of dual-contact machining on standard spindles too!

See an on machine demonstration video of DualDRIVE compared to standard toolholders at: www.techniksusa.com/videos2008/DD



CoolBLAST Coolant

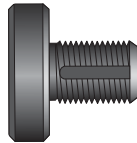

CoolBLAST arbor screw provides coolant path. Order on page 121.

Features

- Compatible with all coolant-thru face mills
- H6 arbor tolerance for less chatter and better tool life
- Use with your existing dual contact spindles

DualDRIVE For dual contact & standard spindles

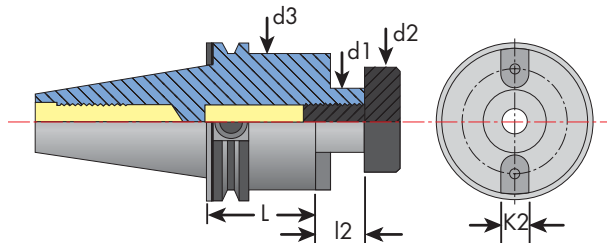
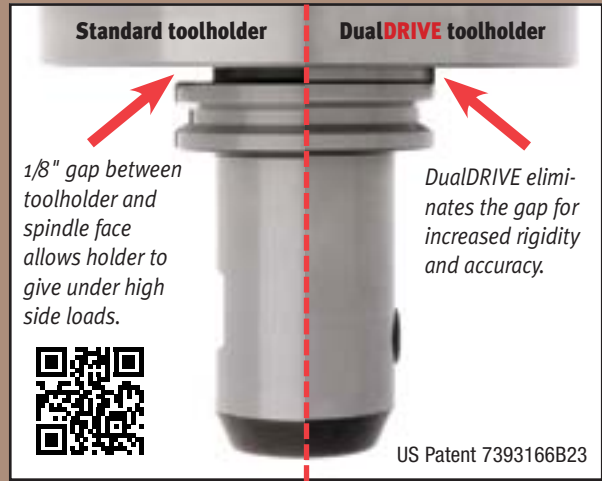

CAT50 DualDRIVE Face Mill Arbors

Part No.	Description	L	l2	d1	d2	d3	K2
72721	CAT50 x FMA 3/4" - 1.5" DualDRIVE	1.5"	.69"	3/4"	.88"	2.75"	.31"
72721-3.5	CAT50 x FMA 3/4" - 3.5" DualDRIVE	3.5"	.69"	3/4"	.88"	1.69"	.31"
72721-5.5	CAT50 x FMA 3/4" - 5.5" DualDRIVE	5.5"	.69"	3/4"	.88"	1.69"	.31"
72723	CAT50 x FMA 1.0" - 2" DualDRIVE	2"	.69"	1.0"	1.19"	2.2"	.38"
72723-4	CAT50 x FMA 1.0" - 4" DualDRIVE	4"	.69"	1.0"	1.19"	2.2"	.38"
72723-6	CAT50 x FMA 1.0" - 6" DualDRIVE	6"	.69"	1.0"	1.19"	2.2"	.38"
72725	CAT50 x FMA 1-1/4" - 1.5" DualDRIVE	1.5"	.69"	1-1/4"	1.5"	2.75"	.5"
72725-3.5	CAT50 x FMA 1-1/4" - 3.5" DualDRIVE	3.5"	.69"	1-1/4"	1.5"	2.75"	.5"
72725-6	CAT50 x FMA 1-1/4" - 6" DualDRIVE	6"	.69"	1-1/4"	1.5"	2.75"	.5"
72727	CAT50 x FMA 1-1/2" - 2.4" DualDRIVE	2.4"	.94"	1-1/2"	1.88"	3.8"	.63"
72727-4	CAT50 x FMA 1-1/2" - 4" DualDRIVE	4"	.94"	1-1/2"	1.88"	3.8"	.63"
72727-6	CAT50 x FMA 1-1/2" - 6" DualDRIVE	6"	.94"	1-1/2"	1.88"	3.8"	.63"
72727-8	CAT50 x FMA 1-1/2" - 8" DualDRIVE	8"	.94"	1-1/2"	1.88"	3.8"	.63"
72729	CAT50 x FMA 2" - 2.4" DualDRIVE	2.4"	.94"	2"	2.5"	4.88"	.75"
72729-4	CAT50 x FMA 2" - 4" DualDRIVE	4"	.94"	2"	2.5"	4.88"	.75"

BT30 DualDRIVE and BT30 Precision Face Mill Arbors



Techniks Certified for accuracy

Features

- Compatible with all coolant-thru face mills
- H6 arbor tolerance for less chatter and better tool life
- Use with your existing dual contact spindles

Benefits

- Better rigidity and reduced vibration (chatter)
- Improved performance at high metal removal rates and when machining at extended lengths
- Provides the benefits of dual-contact machining on standard spindles too!

See an on machine demonstration video of DualDRIVE compared to standard toolholders at: www.techniksusa.com/videos2008/DD

CoolBLAST Coolant Option

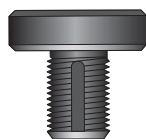

CoolBLAST arbor screw provides coolant path. Order on page 121.

BT30 DualDRIVE Face Mill Arbors

Part No.	Description d1 – l1	L	l2	d1	d2	d3	K2
66610	BT30 x DualDRIVE FMA 3/4" - 2"	2"	.69"	3/4"	.88"	1.66"	.313"
66612-2	BT30 x DualDRIVE FMA 1.0" - 2"	2"	.69"	1.0"	1.18"	2.2"	.375"



Features

- H6 arbor tolerance for less chatter and better tool life
- Each arbor lab certified for accuracy
- Taper ground to AT₃ tolerance for maximum spindle contact

BT30 Precision Face Mill Arbors

Part No.	Description	L	l2	d1	d2	d3	K2
16611	BT30 x 3/4" FMA - 1.18"	1.18"	.69"	3/4"	.88"	1.66"	.313"
16612	BT30 x 1" FMA - 1.77"	1.77"	.69"	1.0"	1.18"	2.2"	.375"
16614	BT30 x 1-1/4" FMA - 1.77"	1.77"	.87"	1-1/4"	1.5"	2.37"	.5"

DualDRIVE For dual contact

Standard toolholder

1/8" gap between toolholder and spindle face allows holder to give under high side loads.

DualDRIVE toolholder

DualDRIVE eliminates the gap for increased rigidity and accuracy.

US Patent 7393166B23

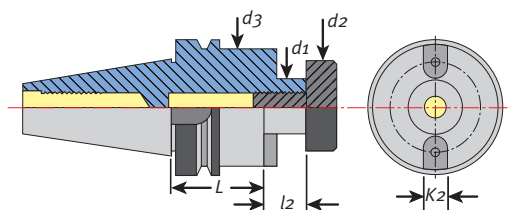

BT40, BT50 Precision Face Mill Arbors



Features

- Compatible with all coolant-thru face mills
- H6 arbor tolerance for less chatter and better tool life
- Each arbor lab certified for accuracy
- Taper ground to AT3 tolerance or better

CoolBLAST Coolant Option

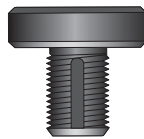

CoolBLAST arbor screw provides coolant path. Order on page 121.



Arbor Screws
pg. 121



Tightening Stands
pg. 206



Retention Knobs
pg. 200



Wrenches
pg. 204

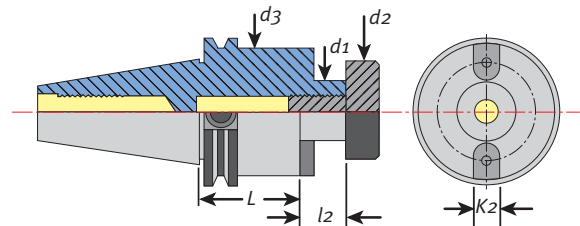

BT40, BT50 Face Mill Arbors

Part No.	Description	L	l2	d1	d2	d3	K2
16615-3/4	BT40 x 3/4" FMA - 1"	1.0"	.69"	3/4"	.88"	1.69"	.313"
16615-4	BT40 x 3/4" FMA - 4.0"	4"	.69"	3/4"	.88"	1.69"	.313"
16615-6	BT40 x 3/4" FMA - 6.0"	6"	.69"	3/4"	.88"	1.69"	.313"
16615	BT40 x 1.0" FMA - 1.77"	1.77"	.69"	1.0"	1.18"	2.2"	.375"
16617	BT40 x 1.0" FMA - 3.54"	3.54"	.69"	1.0"	1.18"	2.2"	.375"
16620	BT40 x 1-1/4" FMA - 1.77"	1.77"	.69"	1-1/4"	1.5"	2.75"	.5"
16620-4	BT40 x 1-1/4" FMA - 4"	4"	.69"	1-1/4"	1.5"	2.75"	.5"
16626	BT40 x 1-1/2" FMA - 2.36"	2.36"	.94"	1-1/2"	1.88"	3.8"	.625"
16639	BT50, 1.0" FMA - 1.77"	1.77"	.79"	1.0"	1.19"	1.97"	.375"
16639-3	BT50, 1.0" FMA - 3"	3"	.79"	3"	1.19"	1.97"	.375"
16642	BT50, 1-1/4" FMA - 1.77"	1.77"	.87"	1-1/4"	1.5"	2.34"	.5"
16645	BT50, 1-1/2" FMA - 1.77"	1.77"	.94"	1-1/2"	1.88"	3.8"	.625"
16646	BT50, 1-1/2" FMA - 75mm	75mm	.94"	1-1/2"	1.88"	3.8"	.625"
16646105	BT50, 1-1/2" FMA - 105mm	105mm	.94"	1-1/2"	1.88"	3.8"	.625"
16646150	BT50, 1-1/2" FMA - 150mm	150mm	.94"	1-1/2"	1.88"	3.8"	.625"
16648	BT50, 2.0" FMA - 2.95"	2.95"	.94"	2"	3.13"	4.88"	.75"

HSK63A, 100A Precision Face Mill Arbors



Features

- Compatible with all coolant-thru face mills
- H6 arbor tolerance for less chatter and better tool life
- Each arbor lab certified for accuracy



Arbor
Screws
pg. 121



Tightening
Stands
pg. 206



Retention
Knobs
pg. 200



Wrenches
pg. 204

CoolBLAST Coolant Option

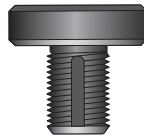

CoolBLAST arbor screw
provides coolant path.
Order on page 121.

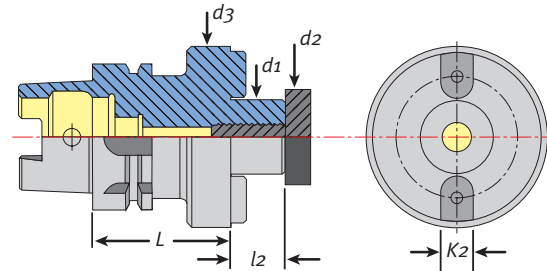

HSK63A Face Mill Arbors

Part No.	Description	L	l2	d1	d2	d3	K2
93500	HSK63A 3/4"FMA - 2"	2"	.687"	3/4"	.875"	1.69"	.313"
93501	HSK63A 1"FMA - 2.37"	2.37"	.687"	1.0"	1.24"	2.2"	.375"
93502	HSK63A 1-1/4"FMA - 2.75"	2.75"	.687"	1-1/4"	1.5"	2.75"	.5"

HSK63A Extended Length Face Mill Arbors

Part No.	Description	L	l2	d1	d2	d3	K2
93510	HSK63A 3/4"FMA - 4"	4"	.687"	3/4"	.875"	1.69"	.313"
93520	HSK63A 1.0"FMA - 4"	4"	.687"	1.0"	1.24"	2.2"	.375"
93530	HSK63A 1-1/4"FMA - 4"	4"	.687"	1-1/4"	1.5"	2.75"	.5"

HSK100A Face Mill Arbors

Part No.	Description	L	l2	d1	d2	d3	K2
95901	HSK100 A 3/4"FMA - 2"	2"	.69"	3/4"	.88"	1.69"	.31"
95903	HSK100 A 1.0"FMA - 2"	2"	.69"	1.0"	1.19"	2.2"	.38"
95905	HSK100 A 1-1/4"FMA - 2-1/2"	2-1/2"	.69"	1-1/4"	1.5"	2.75"	.5"
95907	HSK100 A 1-1/2"FMA - 2-1/2"	2-1/2"	.94"	1-1/2"	1.88"	3.8"	.63"

CoolBLAST and Standard Face Mill Arbor Screws



CoolBLAST arbor screw provides coolant path.

Features

- Compatible with all coolant thru face mills
- Works with all Techniks face mill arbors
- For coolant up to 1,500 PSI

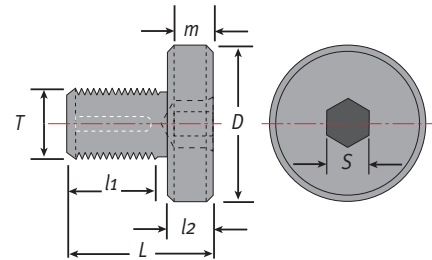

CAT, BT, and HSK CoolBLAST Coolant Arbor Screws

Part No.	Description	Style	Arbor Size	D	L	I1	I2	T	S	m
WF.C1-0.5	CoolBLAST arbor screw 1/2"	B	1/2"	5/8"	.84"	.5"	.34"	1/4"-28UNF	3/16"	.157"
WF.C1-0.75	CoolBLAST arbor screw 3/4"	B	3/4"	7/8"	1.8"	1.4"	.37"	3/8"-24UNF	1/4"	.197"
9851125	CAS-A-0.75 smaller "D"	A	3/4"	5/8"	1.375"	1.0"	.36"	3/8"-24 UNF	1/4"	.37"
WF.C1-1	CoolBLAST arbor screw 1.0"	B	1.0"	1-3/16"	1.4"	0.81"	.37"	1/2"-20UNF	5/16"	.197"
9851135	CAS-A-1.00 smaller "D"	A	1.0"	1.180"	1.375"	1.0"	.38"	1/2"-20UNF	5/16"	.37"
WF.C1-1.25	CoolBLAST arbor screw 1-1/4"	B	1-1/4"	1-1/2"	1.44"	0.94"	.5"	5/8"-18UNF	5/16"	.236"
WF.C1-1.5	CoolBLAST arbor screw 1-1/2"	B	1-1/2"	1-7/8"	1.63"	1.13"	.5"	3/4"-16UNF	3/8"	.276"
WF.C1-2	CoolBLAST arbor screw 2.0"	B	2"	2-1/2"	1.81"	1.31"	.5"	1.0"-14UNF	1/2"	.354"
WF.C1-2.5	CoolBLAST arbor screw 2-1/2"	B	2-1/2"	3-1/8"	2.0"	1.5"	.5"	1.0"-14UNF	1/2"	.354"

CAT, BT, and HSK Standard Arbor Screws

Part No.	Description	Arbor Size	D	L	I1	I2	T	S	m
WF0.5	FMA screw 1/2"	1/2"	5/8"	.84"	.5"	.34"	1/4"-28UNF	3/16"	.157"
WF0.75	FMA screw 3/4"	3/4"	7/8"	1.8"	1.4"	.37"	3/8"-24UNF	1/4"	.197"
WF1	FMA screw 1.0"	1.0"	1-3/16"	1.4"	0.81"	.37"	1/2"-20UNF	5/16"	.197"
WF1.25	FMA screw 1-1/4"	1-1/4"	1-1/2"	1.44"	0.94"	.5"	5/8"-18UNF	5/16"	.236"
WF1.5	FMA screw 1-1/2"	1-1/2"	1-7/8"	1.63"	1.13"	.5"	3/4"-16UNF	3/8"	.276"
WF2	FMA screw 2.0"	2"	2-1/2"	1.81"	1.31"	.5"	1.0"-14UNF	1/2"	.354"
WF2.5	FMA screw 2-1/2"	2-1/2"	3-1/8"	2.0"	1.5"	.5"	1.0"-14UNF	1/2"	.354"

CAT & HSK High-Performance Milling Chucks



Each Techniks High-Performance Milling Chuck is inspected, tested, and certified for quality, accuracy, and holding power. A full lab report is included with each holder.

CoolBLAST Coolant Option



Features

- Each chuck individually tested for holding power
- Nut contacts the flange when properly tightened (prevents overtightening)
- CoolBLAST coolant cap and Black Gold coolant rings for coolant-thru tools

3/4" chuck shown. Use sleeves (page 124) to change tool shank sizes just like collets.

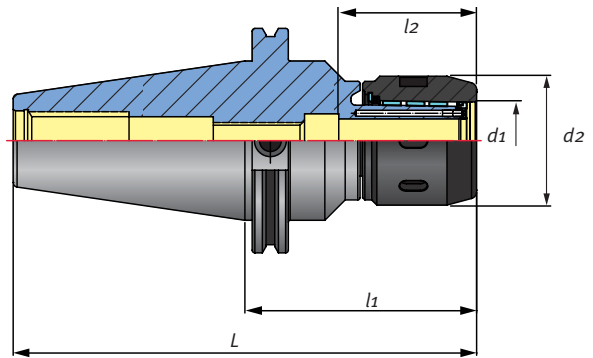

High-Performance 3/4" CAT Milling Chucks

Part No.	Description	L	l1	l2	d1	d2
23202G	CAT40 x MLD 3/4" - 4"	6.69"	4.00"	2.38"	0.75"	2.24"
23214G	CAT50 x MLD 3/4" - 4"	8.00"	4.00"	2.38"	0.75"	2.24"



1-1/4" chuck shown with optional CoolBLAST coolant cap and Black Gold coolant ring. (See next page for details)

Special slotted design (right) of bore I.D. increases holding power and reduces vibration.



High-precision, individually matched needle bearings are symmetrically placed for smooth and reliable operation.

Machined bearing cage ensures accuracy and gripping force.

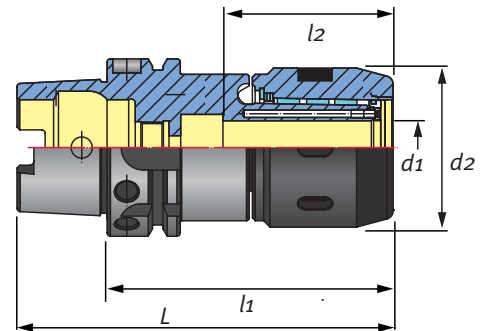
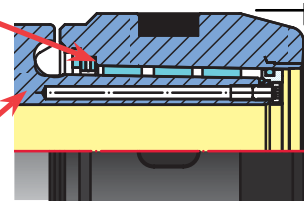

High-Performance 1-1/4" CAT & HSK Milling Chucks

Part No.	Description	L	l1	l2	d1	d2
23210G	CAT40 x MLD 1-1/4" - 4.2"	6.89"	4.20"	2.38"	1.25"	2.80"
23222G	CAT50 x MLD 1-1/4" - 4.13"	8.13"	4.13"	2.38"	1.25"	2.80"
33236G	HSK63A x MLD 1-1/4" - 4.72"	5.98"	4.72"	2.65"	1.25"	2.80"
33256G	HSK100A x MLD 1-1/4" - 4.72"	6.70"	4.72"	2.65"	1.25"	2.79"

CAT40, 50 High-Performance DualDRIVE Milling Chucks



3/4" chuck shown with optional CoolBLAST coolant cap and Black Gold coolant ring.

See an on machine demonstration video of DualDRIVE compared to standard toolholders at: www.techniksusa.com/videos2008/DD

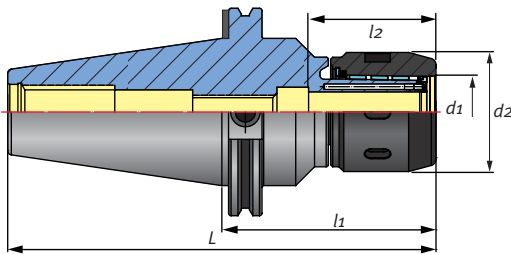

Features

- Use with existing dual-contact machines
- Each chuck individually tested for holding power
- Nut contacts the flange when properly tightened (prevents overtightening)

DualDRIVE For dual contact

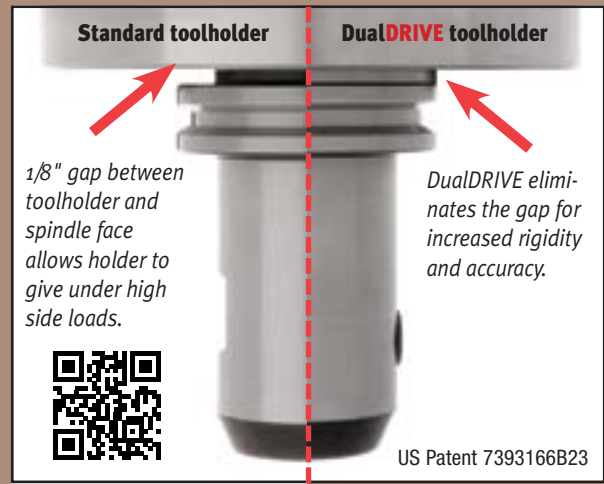

High-Performance Milling Chucks with DualDRIVE

Part No.	Description	L	l1	l2	d1	d2
73202G	CAT40 x MLD 3/4" - 4" DualDRIVE	6.69"	4.00"	2.38"	0.75"	2.24"
73214G	CAT50 x MLD 3/4" - 4" DualDRIVE	8.00"	4.00"	2.38"	0.75"	2.24"
73210G	CAT40 x MLD 1-1/4" - 4.2" DualDRIVE	6.89"	4.20"	2.38"	1.25"	2.80"
73222G	CAT50 x MLD 1-1/4" - 4.13" DualDRIVE	8.13"	4.13"	2.38"	1.25"	2.80"

CoolBLAST Coolant Cap Option

Use CoolBLAST coolant cap and Black Gold ring for coolant-thru tools.

- Maximum chip removal, increase feed rates, extend tool life



Insert Black Gold coolant ring into cap



Cap screws onto end of milling chuck



Remove o-ring for CoolBLAST coolant using standard tools.



Use CoolBLAST coolant cap with Black Gold ER25 or ER40 coolant rings. See page 64

Part No.	Description	Ring
19496G	For 3/4" chuck	ER25
19489G	For 1-1/4" chuck	ER40

Precision Reduction Sleeves for Milling Chucks



Use sleeves to change tool shank sizes just like you would collets.

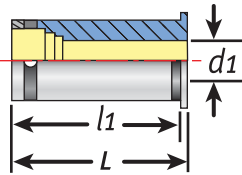

Milling Chuck Reduction Sleeves

- For inch and metric shanks
- T.I.R only .0001"
- All surfaces precision ground for maximum accuracy
- Maximize your milling chuck capability

Special slotted design (right) of bore I.D. increases holding power and reduces vibration.

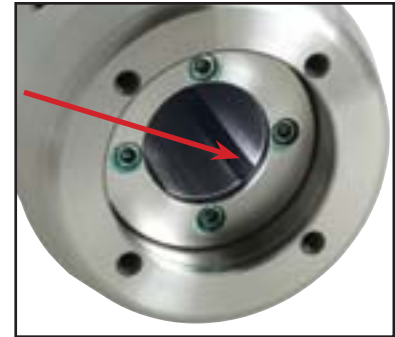

Insert sleeve into chuck, then insert cutting tool, and tighten chuck last.

3/4" O.D. Reduction Sleeves for 3/4" Chucks

Part No.	Description	d1	l1	L
84126-1/8	3/4" O.D., x 1/8" I.D.	1/8"	1.93"	2.09"
84126-3/16	3/4" O.D., x 3/16" I.D.	3/16"	1.93"	2.09"
84126-1/4	3/4" O.D., x 1/4" I.D.	1/4"	1.93"	2.09"
84126-5/16	3/4" O.D., x 5/16" I.D.	5/16"	1.93"	2.09"
84126-3/8	3/4" O.D., x 3/8" I.D.	3/8"	1.93"	2.09"
84126-7/16	3/4" O.D., x 7/16" I.D.	7/16"	1.93"	2.09"
84126-1/2	3/4" O.D., x 1/2" I.D.	1/2"	1.93"	2.09"
84126-9/16	3/4" O.D., x 9/16" I.D.	9/16"	1.93"	2.09"
84126-5/8	3/4" O.D., x 5/8" I.D.	5/8"	1.93"	2.09"
84126-06	3/4" O.D., x 6mm I.D.	6mm	1.93"	2.09"
84126-08	3/4" O.D., x 8mm I.D.	8mm	1.93"	2.09"
84126-10	3/4" O.D., x 10mm I.D.	10mm	1.93"	2.09"
84126-12	3/4" O.D., x 12mm I.D.	12mm	1.93"	2.09"

1-1/4" O.D. Reduction Sleeves for 1-1/4" Chucks

Part No.	Description	d1	l1	L
84127-1/8	1-1/4" O.D., x 1/8" I.D.	1/8"	2.56"	2.75"
84127-3/16	1-1/4" O.D., x 3/16" I.D.	3/16"	2.56"	2.75"
84127-1/4	1-1/4" O.D., x 1/4" I.D.	1/4"	2.56"	2.75"
84127-5/16	1-1/4" O.D., x 5/16" I.D.	5/16"	2.56"	2.75"
84127-3/8	1-1/4" O.D., x 3/8" I.D.	3/8"	2.56"	2.75"
84127-7/16	1-1/4" O.D., x 7/16" I.D.	7/16"	2.56"	2.75"
84127-1/2	1-1/4" O.D., x 1/2" I.D.	1/2"	2.56"	2.75"
84127-9/16	1-1/4" O.D., x 9/16" I.D.	9/16"	2.56"	2.75"
84127-5/8	1-1/4" O.D., x 5/8" I.D.	5/8"	2.56"	2.75"
84127-3/4	1-1/4" O.D., x 3/4" I.D.	3/4"	2.56"	2.75"
84127-7/8	1-1/4" O.D., x 7/8" I.D.	7/8"	2.56"	2.75"
84127-1	1-1/4" O.D., x 1.0" I.D.	1.0"	2.56"	2.75"
84127-08	1-1/4" O.D., x 8mm I.D.	8mm	2.56"	2.75"
84127-10	1-1/4" O.D., x 10mm I.D.	10mm	2.56"	2.75"
84127-12	1-1/4" O.D., x 12mm I.D.	12mm	2.56"	2.75"
84127-14	1-1/4" O.D., x 14mm I.D.	14mm	2.56"	2.75"
84127-16	1-1/4" O.D., x 16mm I.D.	16mm	2.56"	2.75"
84127-20	1-1/4" O.D., x 20mm I.D.	20mm	2.56"	2.75"
84127-25	1-1/4" O.D., x 25mm I.D.	25mm	2.56"	2.75"

Precision CAT and BT Morse Taper Toolholders



Techniks Certified Tooling Features

- Taper ground to AT3 accuracy or better
- .0002" runout from taper to tool pocket
- Each holder lab certified



Tightening
Stands
pg. 206



Retention
Knobs
pg. 200



Wrenches
pg. 204

CAT Morse Taper Toolholders

Part No.	Taper	Size	L1	d1	d2	D
22611	CAT40 Morse Taper	MT#1	1.75"	.475"	.984"	2.5"
22613	CAT40 Morse Taper	MT#2	2."	.7"	1.26"	2.5"
22615	CAT40 Morse Taper	MT#3	2.75"	.937"	1.575"	2.5"
22617	CAT40 Morse Taper	MT#4	3.75"	1.231"	1.889"	2.5"
22623	CAT50 Morse Taper	MT#2	2.36"	.7"	1.26"	3.875"
22625	CAT50 Morse Taper	MT#3	2.56"	.937"	1.575"	3.875"
22627	CAT50 Morse Taper	MT#4	3.75"	1.231"	1.889"	3.875"
22629	CAT50 Morse Taper	MT#5	4.13"	1.75"	2.48"	3.875"

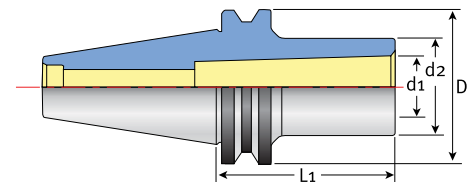

BT Morse Taper Toolholders

Part No.	Taper	Size	L1	d1	d2	D
17001	BT30 Morse Taper	MT#1	1.77"	.475"	.984"	1.811"
17006	BT30 Morse Taper	MT#2	2.36"	.7"	1.26"	1.811"
17010	BT30 Morse Taper	MT#3	3.14"	.937"	1.575"	1.811"
17011	BT40 Morse Taper	MT#1	1.77"	.475"	.984"	2.48"
17014	BT40 Morse Taper	MT#2	1.96"	.7"	1.26"	2.48"
17018	BT40 Morse Taper	MT#3	2.75"	.937"	1.575"	2.48"
17023	BT40 Morse Taper	MT#4	3.75"	1.231"	1.889"	2.48"
17036	BT50 Morse Taper	MT#2	2.36"	.7"	1.26"	3.937"
17039	BT50 Morse Taper	MT#2-135	5.31"	.7"	1.26"	3.937"
17042	BT50 Morse Taper	MT#3	2.56"	.937"	1.575"	3.937"
17046	BT50 Morse Taper	MT3-150	5.9"	.937"	1.575"	3.937"
17048	BT50 Morse Taper	MT#4	3.74"	1.231"	1.889"	3.937"
17051	BT50 Morse Taper	MT4-180	7.08"	1.231"	1.889"	3.937"
17053	BT50 Morse Taper	MT#5	4.13"	1.75"	2.48"	3.937"

Precision Hydraulic Toolholders



Features

- Repeatability, accuracy 3 microns
- Balance 15,000 RPM
- Excellent vibration damping
- Rapid tool changes (no fixture required)



Tightening
Stands
pg. 206



Retention
Knobs
pg. 200



Wrenches
pg. 204



A special groove in the bore captures oil and coolant to improve gripping force.

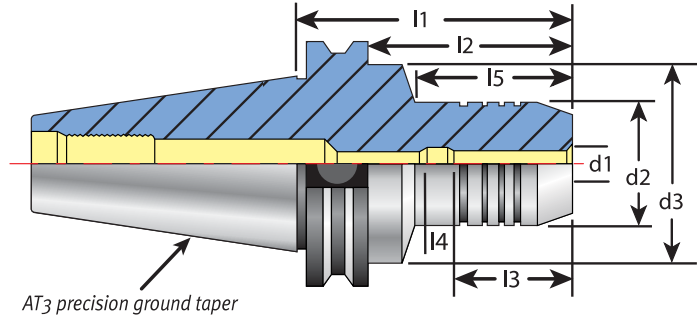

CAT40, CAT50, Hydraulic Toolholders

Part No.	Description	d1	d2	d3	I1	I2	I3	I4	I5
24937	CAT40 Hydro x 20mm	20mm	42mm	44.5mm	82mm	63mm	42mm	10mm	47mm
24954	CAT40 Hydro x 3/4"	3/4"	42mm	44.5mm	82mm	63mm	42mm	10mm	47mm
17954	CAT50 Hydro x 3/4"	3/4"	42mm	70mm	82mm	63mm	42mm	10mm	47mm
17955	CAT50 Hydro x 1-1/4"	1-1/4"	60mm	70mm	91mm	72mm	52mm	10mm	56mm
17937	CAT50 Hydro x 20mm	20mm	42mm	70mm	82mm	63mm	42mm	10mm	47mm

Precision Reduction Sleeves for Hydraulic Toolholders



Features

- Use sleeves with your hydraulic toolholders to run a variety of shank sizes
- T.I.R. of only .00012"
- Sealed to 1,000 P.S.I. for coolant applications

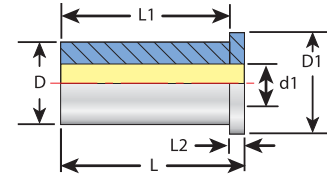

Inch O.D. / Inch I.D. Reduction Sleeves for Hydraulic Toolholders

Part No.	Description	d1	D	D1	L	L1	L2
19474-1/8	3/4" OD - 1/8" ID	.125"	.75"	.945"	2.083"	2.003"	.079"
19474-3/16	3/4" OD - 3/16" ID	.1875"	.75"	.945"	2.083"	2.003"	.079"
19474-1/4	3/4" OD - 1/4" ID	.25"	.75"	.945"	2.083"	2.003"	.079"
19474-5/16	3/4" OD - 5/16" ID	.3125"	.75"	.945"	2.083"	2.003"	.079"
19474-3/8	3/4" OD - 3/8" ID	.375"	.75"	.945"	2.083"	2.003"	.079"
19474-7/16	3/4" OD - 7/16" ID	.4375"	.75"	.945"	2.083"	2.003"	.079"
19474-1/2	3/4" OD - 1/2" ID	.5"	.75"	.945"	2.083"	2.003"	.079"
19474-5/8	3/4" OD - 5/8" ID	.625"	.75"	.945"	2.083"	2.003"	.079"
19478-1/4	1-1/4" OD - 1/4" ID	.25"	1.25"	1.575"	2.598"	2.441"	.157"
19478-5/16	1-1/4" OD - 5/16" ID	.3125"	1.25"	1.575"	2.598"	2.441"	.157"
19478-3/8	1-1/4" OD - 3/8" ID	.375"	1.25"	1.575"	2.598"	2.441"	.157"
19478-1/2	1-1/4" OD - 1/2" ID	.5"	1.25"	1.575"	2.598"	2.441"	.157"
19478-5/8	1-1/4" OD - 5/8" ID	.625"	1.25"	1.575"	2.598"	2.441"	.157"
19478-3/4	1-1/4" OD - 3/4" ID	.75"	1.25"	1.575"	2.598"	2.441"	.157"
19478-7/8	1-1/4" OD - 7/8" ID	.875"	1.25"	1.575"	2.598"	2.441"	.157"
19478-01	1-1/4" OD - 1" ID	1.0"	1.25"	1.575"	2.598"	2.441"	.157"

Metric O.D. / Inch I.D. Reduction Sleeves for Hydraulic Toolholders

Part No.	Description	d1	D	D1	L	L1	L2
19462-1/4	20mm OD - 1/4" ID	.25"	20mm	24mm	52.9mm	50.9mm	2mm
19462-5/16	20mm OD - 5/16" ID	.3125"	20mm	24mm	52.9mm	50.9mm	2mm
19462-3/8	20mm OD - 3/8" ID	.375"	20mm	24mm	52.9mm	50.9mm	2mm
19462-7/16	20mm OD - 7/16" ID	.4375"	20mm	24mm	52.9mm	50.9mm	2mm
19462-1/2	20mm OD - 1/2" ID	.5"	20mm	24mm	52.9mm	50.9mm	2mm
19462-5/8	20mm OD - 5/8" ID	.625"	20mm	24mm	52.9mm	50.9mm	2mm

Metric O.D. / Metric I.D. Reduction Sleeves for Hydraulic Toolholders

Part No.	Description	d1	D	D1	L	L1	L2
19462-06	20mm OD - 6mm ID	6mm	20mm	24mm	52.90mm	50.9mm	2mm
19462-08	20mm OD - 8mm ID	8mm	20mm	24mm	52.90mm	50.9mm	2mm
19462-10	20mm OD - 10mm ID	10mm	20mm	24mm	52.90mm	50.9mm	2mm
19462-12	20mm OD - 12mm ID	12mm	20mm	24mm	52.90mm	50.9mm	2mm
19462-14	20mm OD - 14mm ID	14mm	20mm	24mm	52.90mm	50.9mm	2mm
19462-16	20mm OD - 16mm ID	16mm	20mm	24mm	52.90mm	50.9mm	2mm

CAT40 and CAT50 SIMIS ER Collet Chucks

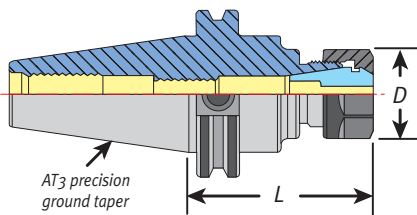

Comparison of SIMIS and Techniks Certified Collet Chucks

	SIMIS	Techniks Certified
Lab Certified for Accuracy & Balance	NO	YES
Collet Nut Included	YES - Uncoated	YES - PowerCOAT
Balance Specification	18,000 RPMs	25,000 RPMs
DIN B Coolant Available	NO	YES
Available Sizes	Most Common	Wide Selection

ER Nut Included



Part No.	Description
11116	ER16 uncoated hex nut
11120	ER20 uncoated hex nut
11125	ER25 uncoated slotted nut
11132	ER32 uncoated slotted nut
11140	ER40 uncoated slotted nut

CAT40 ER Toolholders

Part No.	Description	L	D	Collet	Max. Shank	Stop Screw	Wrench
CAT40ER11-3	CAT40 x ER11-3"	3	.748"	ER11	.275"	06081	04608
CAT40ER11-4	CAT40 x ER11-4"	4	.748	ER11	.275"	06081	04608
CAT40ER11-6	CAT40 x ER11-6"	6	.748	ER11	.275"	06081	04608
CAT40ER16-2.76	CAT40 x ER16-2.76"	2.76"	1.08"	ER16	.406"	06083	04609 hex
CAT40ER16-4	CAT40 x ER16-4"	4"	1.08"	ER16	.406"	06083	04609 hex
CAT40ER20-2.76	CAT40 x ER20-2.76"	2.76"	1.34"	ER20	.512"	06087	04610 hex
CAT40ER20-4	CAT40 x ER20-4"	4"	1.34"	ER20	.512"	06087	04610 hex
CAT40ER20-6	CAT40 x ER20-6"	6"	1.34"	ER20	.512"	06087	04610 hex
CAT40ER25-2.76	CAT40 x ER25-2.76"	2.76"	1.65"	ER25	.63"	06089	04615
CAT40ER25-4	CAT40 x ER25-4"	4"	1.65"	ER25	.63"	06089	04615
CAT40ER32-2.76	CAT40 x ER32-2.76"	2.76"	1.97"	ER32	.788"	06089	04616
CAT40ER32-4	CAT40 x ER32-4"	4"	1.97"	ER32	.788"	06089	04616
CAT40ER40-3.15	CAT40 x ER40-3.15"	3.15"	2.48"	ER40	1.023"	06091	04617

CAT50 ER Toolholders

Part No.	Description	L	D	Collet	Max. Shank	Stop Screw	Wrench
CAT50ER16-4	CAT50 x ER16-4	4"	1.08"	ER16	.406"	06083	04609 hex
CAT50ER16-6	CAT50 x ER16-6	6"	1.08"	ER16	.406"	06083	04609 hex
CAT50ER20-4	CAT50 x ER20-4	4"	1.34"	ER20	.512"	06087	04610 hex
CAT50ER20-6	CAT50 x ER20-6	6"	1.34"	ER20	.512"	06087	04610 hex
CAT50ER32-4	CAT50 x ER32-4	4"	1.97"	ER32	.788"	06089	04616
CAT50ER32-6	CAT50 x ER32-6	6"	1.97"	ER32	.788"	06089	04616
CAT50ER40-4	CAT50 x ER40-4	4"	2.48"	ER40	1.023"	06091	04617

CAT40 and CAT50 SIMIS End Mill Holders



Comparison of SIMIS and Techniks Certified Endmill Holders

	SIMIS	Techniks Certified
Lab Certified for Accuracy & Balance	NO	YES
Balance Specification	8,000 RPMs	10,000 RPMs
DIN B Coolant Available	NO	YES
End Mill Bore Tolerance	H7	H5
Available Sizes	Most Common	Wide Selection



Tightening
Stands
pg. 206



Retention
Knobs
pg. 200



Wrenches
pg. 204

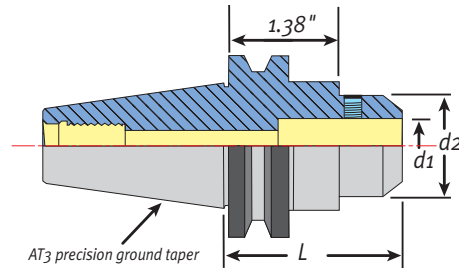

CAT40 End Mill Holders

Part No.	Description – d1	L	d2
CAT40SLN1/8	CAT40 x SLN - 1/8"	2.375"	.69"
CAT40SLN3/16	CAT40 x SLN - 3/16"	2.5"	.69"
CAT40SLN1/4	CAT40 x SLN - 1/4"	3"	.78"
CAT40SLN1/4-1.75	CAT40 x SLN - 1/4"	1.75"	.795"
CAT40SLN3/8	CAT40 x SLN - 3/8"	3"	.88"
CAT40SLN3/8-1.75	CAT40 x SLN - 3/8"	1.75"	.88"
CAT40SLN1/2	CAT40 x SLN - 1/2"	3"	1.25"
CAT40SLN1/2-1.75	CAT40 x SLN - 1/2"	1.75"	1.5"
CAT40SLN5/8	CAT40 x SLN - 5/8"	3"	1.5"
CAT40SLN3/4	CAT40 x SLN - 3/4"	3.5"	1.75"
CAT40SLN3/4-1.75	CAT40 x SLN - 3/4"	1.75"	1.75"
CAT40SLN1	CAT40 x SLN - 1.0"	4"	2"
CAT40SLN1-1.75	CAT40 x SLN - 1.0"	1.75"	1.75"
CAT40SLN1 1/4-2	CAT40 x SLN - 1-1/4"	2"	1.75"

CAT50 Endmill Holders

Part No.	Description – d1	d2	L
CAT50SLN1/4	CAT50 x SLN - 1/4"	.78	4"
CAT50SLN3/8	CAT50 x SLN - 3/8"	1.0"	4"
CAT50SLN1/2	CAT50 x SLN - 1/2"	1.25"	4"
CAT50SLN5/8	CAT50 x SLN - 5/8"	1.5"	4"
CAT50SLN3/4	CAT50 x SLN - 3/4"	1.75"	4"
CAT50SLN1	CAT50 x SLN - 1.0"	2"	4"
CAT50SLN11/4	CAT50 x SLN - 1-1/4"	2.5"	4.6"

Keyless Drill Chucks



Our HP3 High-Precision Drill Chucks have the flexibility to hold a wide range of shank sizes and deliver superior performance too. Maximum runout (T.I.R.) is only .0008".

They also feature a one-piece design that provides greater rigidity and safety because the chuck cannot break free during operation.



CAT and BT SPU Drill Chucks

Part No.	Description	l1	L	D	d1
22403	CAT40 SPU x 1/2" - 4"	101.6mm	169.9mm	63.5mm	50mm
22405	CAT50 SPU x 1/2" - 4"	101.6mm	203.2mm	98.4mm	50mm
16456-W	BT30 x SPU x 13mm - 110mm (no slots)	110mm	170.4mm	46mm	50mm
06456	BT30 x SPU x 13mm - 110mm	110mm	170.4mm	46mm	50mm
16466	BT40 x SPU x 13mm - 100mm	100mm	177.4mm	63mm	50mm
06476	BT50 x SPU x 13mm - 100mm	100mm	213.8mm	100mm	50mm
01250-13S	SPU drill chuck wrench (replacement)				

Features

- For milling machines & drilling machines
- All hardened parts for long life and safety
- Use with CAT or BT holders (opposite)

Keyless Jacobs Taper Drill Chucks

Part No.	Description	Length Closed	Outer Diameter	Range
02150	08S x JT1	76mm	38mm	0 - 5/16"
02153	13S x JT6	102mm	49mm	0 - 1/2"
02151-JT33	10S x JT33	92mm	43mm	0 - 3/8"
02153-JT33	13S x JT33	102mm	49mm	0 - 1/2"

Features

- Capacity from 1/16" to 1/2"
- 4 times greater holding power
- Balanced to 10,000 RPM

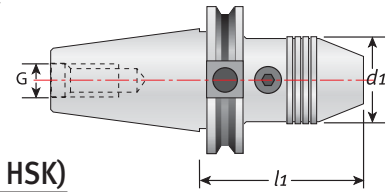

HP3 Precision Drill Toolholders (ISO, BT, HSK)

Part No.	Description	d1	l1	G
171.05.046.003	HSK63F HP3 drill chuck 1/2"	50	123.5	-
64.05.046.051	ISO30 HP3 drill chuck 1/2"	50	103	M12
67.05.046.001	BT30 HP3 drill chuck 1/2"	50	92.5	M12
39.05.046.001	BT40 HP3 drill chuck 1/2"	50	95.5	M16

Features

- 3 times more holding power than other chucks
- Holds non-standard shank sizes up to 1/2"
- Replaceable chuck is held by a drawbolt

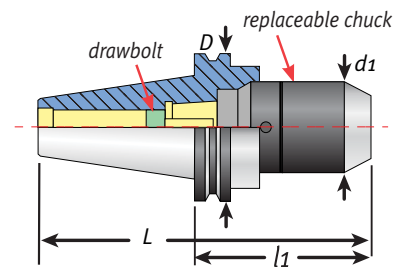

CAT and BT Toolholders For Jacobs Taper Drill Chucks



Features

- Better T.I.R. and rigidity than standard drill chucks
- Taper ground to AT3 accuracy
- Use with keyless Jacobs chucks

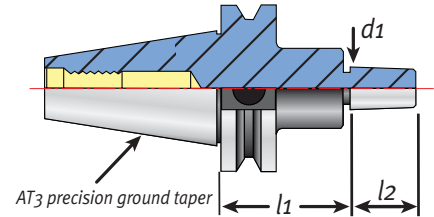

CAT Toolholders For Jacobs Taper Drill Chucks

Part No.	Description	l1	l2	d1	Jacobs Taper
22511	CAT40 x JT2 - 1.57"	1.57"	.875"	.559"	2
22512	CAT40 x JT3 - 1.57"	1.57"	1.2"	.811"	3
22513	CAT40 x JT6 - 1.57"	1.57"	.945"	.676"	6
22515	CAT40 x JT33 - 1.57"	1.57"	.945"	.624"	33
22521	CAT50 x JT2 - 1.57"	1.57"	.875"	.559"	2
22527	CAT50 x JT3 - 1.57"	1.57"	1.2"	.811"	3
22529	CAT50 x JT4 - 1.57"	1.57"	1.656"	1.124"	4
22531	CAT50 x JT5 - 1.57"	1.57"	1.875"	1.413"	5
22523	CAT50 x JT6 - 1.57"	1.57"	.945"	.676"	6
22525	CAT50 x JT33 - 1.57"	1.57"	.945"	.624"	33

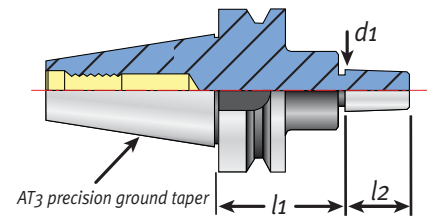

BT Toolholders For Jacobs Taper Drill Chucks

Part No.	Description	l1	l2	d1
16502	BT30 x JT2 - 45mm	45mm	20mm	14.199
16504	BT30 x JT33 - 45mm	45mm	24mm	15.850
16506	BT30 x JT6 - 45mm	45mm	24mm	17.170
16522	BT40 x JT2 - 45mm	45mm	20mm	14.199
16523	BT40 x JT33 - 45mm	45mm	24mm	15.850
16524	BT40 x JT6 - 45mm	45mm	24mm	17.170
16542	BT50 x JT2 - 45mm	45mm	20mm	14.199
16543	BT50 x JT33 - 45mm	45mm	24mm	15.850
16544	BT50 x JT6 - 45mm	45mm	24mm	17.170

Measurement Guide For Special Order Toolholders

V-flange CNC machine make, model and spindle

V-Flange tool #1 dimensions

D = _____
 F = _____
 W = _____
 A = _____
 N = _____

V-Flange tool #2 dimensions

D = _____
 F = _____
 W = _____
 A = _____
 N = _____

HSK CNC machine make, model and spindle

HSK tool #1 dimensions

D = _____
 F = _____
 W = _____
 A = _____
 N = _____

HSK tool #2 dimensions

D = _____
 F = _____
 W = _____
 A = _____
 N = _____

Fill in all the required dimensions (left).
 Then, fax or phone in your order for a fast quote.

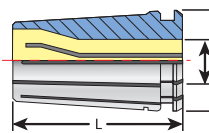
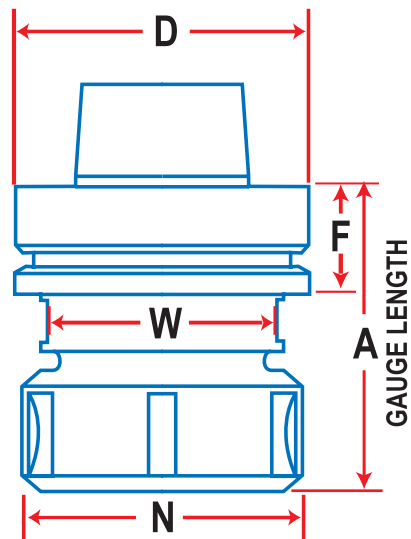
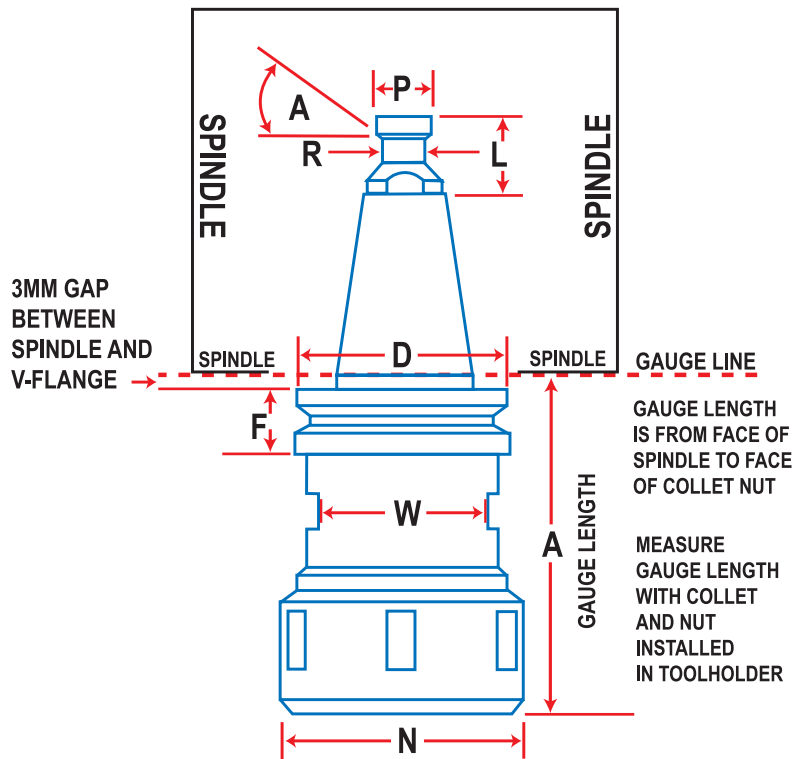

For special order collets see page 72.

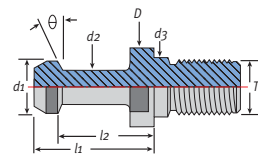

Call for special order retention knobs.