

Precision ER Collets, PowerCOAT Nuts, Other Collets

Full Line of ER Collets

Made from high-carbon bearing steel and heat treated for improved flexibility and longer life.



ER Inch Sizes



Sealed Coolant



Steel Sealed Coolant



ER Metric Sizes



Quick-Change Tap Collet



Floating Tap Collet



Rigid Tap Collet

PowerCOAT Nut

Points of Friction



threads



shoulder



Balanced up to to 70,000 RPMs

Our special PowerCOAT nut reduces friction so it can increase holding power by 75% compared to standard nuts. Holding power increases cutting tool life.

Other Collet Styles



DNA Dead Nuts
Accurate ER



TG75, TG100,
TG150



SYOZ / EOC
Perske



DA Double
Angle

You lose 10% of tool life for every .0001" of T.I.R.
The holding power and accuracy of Techniks collets
and PowerCOAT nuts extend cutting tool life.

Built for Speed.

Inch Size Precision ER Collets and Collet Sets

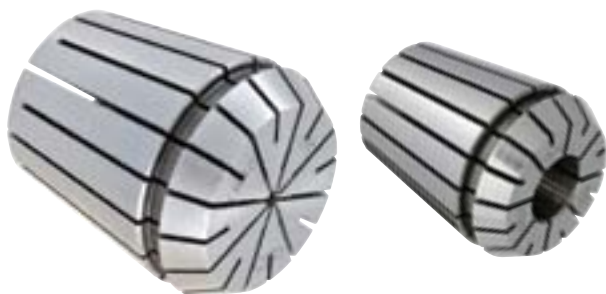

Inch Size ER Collet Features

- Average .0002" T.I.R.
- Clamping range: .039"
- Use with PowerCOAT nut (pg. 62) for best holding power and cutting tool life.

Compatible with DR, RD, ESX, AR, & BR series collets.

Ultra Precision Collets

- .0002" T.I.R. or better
- To order put "UP" in front of the part number



Nuts
pg. 62



Coolant
Rings
pg. 64



Retention
Knobs
pg. 200



Wrenches
pg. 204

ER8 Inch Size Collets

Part No.	Inch Range	Shank
04208-1/16	.043 – .062"	1/16"
04208-1/8	.086 – .125"	1/8"
04208-3/16	.148 – .187"	3/16"

ER Inch Size Collet Sets

Part No.	Size	Pieces	Collets Included	Fits Shank Sizes
04208IS	ER11	7	1/16 – 1/4" by 32nds	1/32 - 1/4"
04209IS	ER16	10	3/32 – 3/8" by 32nds	1/16 - 3/8"
04210IS	ER20	12	5/32 – 1/2" by 32nds	1/8 - 1/2"
04211IS	ER25	16	5/32 – 5/8" by 32nds	1/8 - 5/8"
04212IS	ER32	18	7/32 – 3/4" by 32nds	3/16 - 3/4"
04213IS	ER40	13	1/8 – 1.0" by 16ths	1/8 - 1.0"

ER11 Inch Size Collets

Part No.	Inch Range	Shank
04211-1/16	.043 – .062"	1/16"
04211-3/32	.054 – .093"	3/32"
04211-1/8	.086 – .125"	1/8"
04211-5/32	.117 – .156"	5/32"
04211-3/16	.148 – .187"	3/16"
04211-7/32	.179 – .218"	7/32"
04211-1/4	.211 – .250"	1/4"
04211-9/32	.242 – .281"	9/32"

ER16 Inch Size Collets

Part No.	Inch Range	Shank
04216-1/16	.043 – .062"	1/16"
04216-3/32	.054 – .093"	3/32"
04216-1/8	.086 – .125"	1/8"
04216-5/32	.117 – .156"	5/32"
04216-3/16	.148 – .187"	3/16"
04216-7/32	.179 – .218"	7/32"
04216-1/4	.211 – .250"	1/4"
04216-9/32	.242 – .281"	9/32"
04216-5/16	.273 – .312"	5/16"
04216-11/32	.304 – .343"	11/32"
04216-3/8	.336 – .375"	3/8"
04216-13/32	.367 – .406"	13/32"

ER20 Inch Size Collets

Part No.	Inch Range	Shank
04220-1/16	.043 – .062"	1/16"
04220-3/32	.054 – .093"	3/32"
04220-1/8	.086 – .125"	1/8"
04220-5/32	.117 – .156"	5/32"
04220-3/16	.148 – .187"	3/16"
04220-7/32	.179 – .218"	7/32"
04220-1/4	.211 – .250"	1/4"
04220-9/32	.242 – .281"	9/32"
04220-5/16	.273 – .312"	5/16"
04220-11/32	.304 – .343"	11/32"
04220-3/8	.336 – .375"	3/8"
04220-13/32	.367 – .406"	13/32"
04220-7/16	.398 – .437"	7/16"
04220-15/32	.429 – .468"	15/32"
04220-1/2	.461 – .500"	1/2"

Inch Size Precision ER Collets

ER25 Inch Size Collets

Part No.	Inch Range	Shank
04225-3/32	.054 – .093"	3/32"
04225-1/8	.086 – .125"	1/8"
04225-5/32	.117 – .156"	5/32"
04225-3/16	.148 – .187"	3/16"
04225-7/32	.179 – .218"	7/32"
04225-1/4	.211 – .250"	1/4"
04225-9/32	.242 – .281"	9/32"
04225-5/16	.273 – .312"	5/16"
04225-11/32	.304 – .343"	11/32"
04225-3/8	.336 – .375"	3/8"
04225-13/32	.367 – .406"	13/32"
04225-7/16	.398 – .437"	7/16"
04225-15/32	.429 – .468"	15/32"
04225-1/2	.461 – .500"	1/2"
04225-17/32	.492 – .531"	17/32"
04225-9/16	.523 – .562"	9/16"
04225-19/32	.554 – .593"	19/32"
04225-5/8	.586 – .625"	5/8"
04225-3/4	.711 – .750"	3/4"

ER32 Inch Size Collets

Part No.	Inch Range	Shank
04232-1/16	.043 – .062"	1/16"
04232-3/32	.054 – .093"	3/32"
04232-1/8	.086 – .125"	1/8"
04232-5/32	.117 – .156"	5/32"
04232-3/16	.148 – .187"	3/16"
04232-7/32	.179 – .218"	7/32"
04232-1/4	.211 – .250"	1/4"
04232-9/32	.242 – .281"	9/32"
04232-5/16	.273 – .312"	5/16"
04232-11/32	.304 – .343"	11/32"
04232-3/8	.336 – .375"	3/8"
04232-13/32	.367 – .406"	13/32"
04232-7/16	.398 – .437"	7/16"
04232-15/32	.429 – .468"	15/32"
04232-1/2	.461 – .500"	1/2"
04232-17/32	.492 – .531"	17/32"
04232-9/16	.523 – .562"	9/16"
04232-19/32	.554 – .593"	19/32"
04232-5/8	.586 – .625"	5/8"
04232-21/32	.617 – .656"	21/32"
04232-11/16	.648 – .687"	11/16"
04232-23/32	.679 – .718"	23/32"
04232-3/4	.711 – .750"	3/4"

ER40 Inch Size Collets

Part No.	Inch Range	Shank
04240-1/8	.086 – .125"	1/8"
04240-5/32	.117 – .156"	5/32"
04240-3/16	.148 – .187"	3/16"
04240-7/32	.179 – .218"	7/32"
04240-1/4	.211 – .250"	1/4"
04240-9/32	.242 – .281"	9/32"
04240-5/16	.273 – .312"	5/16"
04240-11/32	.304 – .343"	11/32"
04240-3/8	.336 – .375"	3/8"
04240-13/32	.367 – .406"	13/32"
04240-7/16	.398 – .437"	7/16"
04240-15/32	.429 – .468"	15/32"
04240-1/2	.461 – .500"	1/2"
04240-17/32	.492 – .531"	17/32"
04240-9/16	.523 – .562"	9/16"
04240-19/32	.554 – .593"	19/32"
04240-5/8	.586 – .625"	5/8"
04240-21/32	.617 – .656"	21/32"
04240-11/16	.648 – .687"	11/16"
04240-23/32	.679 – .718"	23/32"
04240-3/4	.711 – .750"	3/4"
04240-25/32	.742 – .781"	25/32"
04240-13/16	.773 – .812"	13/16"
04240-27/32	.807 – .843"	27/32"
04240-7/8	.836 – .875"	7/8"
04240-29/32	.867 – .906"	29/32"
04240-15/16	.898 – .937"	15/16"
04240-31/32	.929 – .968"	31/32"
04240-1	.961 – 1.00"	1.0"

Use the table (below) for selecting your replacement collets. ER collets all have unique length and diameter measurements.

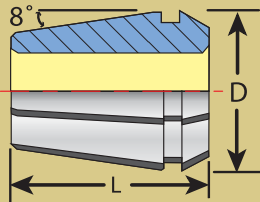

ER Size	L	D
ER8	13mm (.51")	8.5mm (.33")
ER11	18mm (.708")	11.5mm (.45")
ER16	27.5mm (1.08")	17mm (.67")
ER20	31.5mm (1.24")	21mm (.83")
ER25	34mm (1.34")	26mm (1.02")
ER32	40mm (1.57")	33mm (1.3")
ER40	46mm (1.81")	41mm (1.61")
ER50	60 mm (2.36")	52mm (2.05")

ER50 Inch Size Collets

Part No.	Inch Range	Shank
04250-1/2	.461 – .500"	1/2"
04250-5/8	.586 – .625"	5/8"
04250-3/4	.711 – .750"	3/4"
04250-7/8	.836 – .875"	7/8"
04250-1	.961 – 1.00"	1.0"
04250-1-1/4	1.211 – 1.250"	1-1/4"

Metric Size Precision ER Collets and Collet Sets

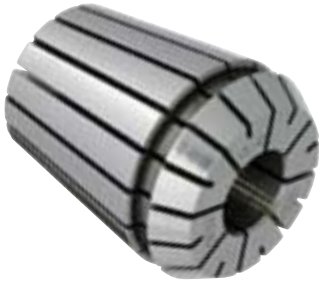

Compatible with DR, RD, ESX, AR, & BR series collets.

To Order Ultra Precision Collets

Hand-selected Ultra Precision collets are guaranteed .0002" T.I.R. or better. Just place "UP" in front of the regular part number when ordering.



Metric ER Precision Collet Features

- Average .0002" T.I.R.
- Clamping range: .039"
- Use with PowerCOAT nut (pg. 62) for best holding power and cutting tool life.

ER Metric Collet Sets

Part No.	Size	Pieces	Collets Included	Fits Shank Sizes
04200MS	ER8	9	1 - 5mm by 0.5mm	.5 – 5mm
04201MS	ER11	13	1 - 7mm by 0.5mm	.5 – 7mm
04202MS	ER16	10	1 - 10mm by 1mm	.5 – 10mm
04203MS	ER20	12	2 - 13mm by 1mm	1.0 – 13mm
04204MS	ER25	15	2 - 16mm by 1mm	1.0 – 16mm
04205MS	ER32	18	3 - 20mm by 1mm	2 – 20mm
04206MS	ER40	23	4 - 26mm by 1mm	3 – 26mm
04207MS	ER50	17	6 - 34mm by 2 mm	5 – 34mm

ER8 Precision Metric Collets

Part No.	Inch Range	Shank
04208-01.0	.019 – .039"	0.5 – 1.0
04208-01.5	.039 – .059"	1.0 – 1.5
04208-02.0	.059 – .079"	1.5 – 2.0
04208-02.5	.079 – .098"	2.0 – 2.5
04208-03.0	.098 – .118"	2.5 – 3.0
04208-03.5	.118 – .138"	3.0 – 3.5
04208-04.0	.138 – .157"	3.5 – 4.0
04208-04.5	.157 – .177"	4.0 – 4.5
04208-05.0	.177 – .197"	4.5 – 5.0

ER11 Precision Metric Collets

Part No.	Inch Range	Shank
04211-01.0	.019 – .039"	0.5 – 1.0
04211-01.5	.039 – .059"	1.0 – 1.5
04211-02.0	.059 – .079"	1.5 – 2.0
04211-02.5	.079 – .098"	2.0 – 2.5
04211-03.0	.098 – .118"	2.5 – 3.0
04211-03.5	.118 – .138"	3.0 – 3.5
04211-04.0	.138 – .157"	3.5 – 4.0
04211-04.5	.157 – .177"	4.0 – 4.5
04211-05.0	.177 – .197"	4.5 – 5.0
04211-05.5	.197 – .217"	5.0 – 5.5
04211-06.0	.217 – .236"	5.5 – 6.0
04211-06.5	.236 – .256"	6.0 – 6.5
04211-07.0	.256 – .276"	6.5 – 7.0

ER16 Precision Metric Collets

Part No.	Inch Range	Shank
04216-01	.019 – .039"	0.5–1
04216-01.5	.039 – .059"	1.0–1.5
04216-02	.039 – .079"	1.5–2
04216-02.5	.059 – .098"	1.5–2.5
04216-03	.079 – .118"	2–3
04216-03.5	.098 – .137"	2.5–3.5
04216-04	.118 – .157"	3–4
04216-04.5	.137 – .177"	3.5–4.5
04216-05	.157 – .197"	4–5
04216-05.5	.177 – .216"	4.5–5.5
04216-06	.197 – .236"	5–6
04216-06.5	.216 – .255"	5.5–6.5
04216-07	.236 – .276"	6–7
04216-07.5	.255 – .295"	6.5–7.5
04216-08	.276 – .315"	7–8
04216-08.5	.295 – .334"	7.5–8.5
04216-09	.315 – .354"	8–9
04216-09.5	.334 – .374"	8.5–9.5
04216-10	.354 – .394"	9–10
04216-10.5	.374 – .413"	9.5–10.5

ER20 Precision Metric Collets

Part No.	Inch Range	Shank
04220-01	.019 – .039"	0.5–1
04220-01.5	.039 – .059"	1.0–1.5
04220-02	.039 – .079"	1.5–2
04220-02.5	.059 – .098"	1.5–2.5
04220-03	.079 – .118"	2–3
04220-03.5	.098 – .137"	2.5–3.5
04220-04	.118 – .157"	3–4
04220-04.5	.137 – .177"	3.5–4.5
04220-05	.157 – .197"	4–5
04220-05.5	.177 – .216"	4.5–5.5
04220-06	.197 – .236"	5–6
04220-06.5	.216 – .255"	5.5–6.5
04220-07	.236 – .276"	6–7
04220-07.5	.255 – .295"	6.5–7.5
04220-08	.276 – .315"	7–8
04220-08.5	.295 – .334"	7.5–8.5
04220-09	.315 – .354"	8–9
04220-09.5	.334 – .374"	8.5–9.5
04220-10	.354 – .394"	9–10
04220-10.5	.374 – .413"	9.5–10.5
04220-11	.394 – .433"	10–11
04220-11.5	.413 – .452"	10.5–11.5
04220-12	.433 – .472"	11–12
04220-12.5	.452" – .492"	11.5–12.5
04220-13	.472 – .512"	12–13
04220-13.5	.492 – .531"	12.5–13.5
04220-14	.512 – .551"	13–14

Metric Size Precision ER Collets

ER25 Precision Metric Collets

Part No.	Inch Range	Shank mm
04225-02	.039 – .079"	1.5–2
04225-02.5	.059 – .098"	2–2.5
04225-03	.079 – .118"	2–3
04225-03.5	.098 – .137"	2.5–3.5
04225-04	.118 – .157"	3–4
04225-05	.157 – .197"	4–5
04225-06	.197 – .236"	5–6
04225-07	.236 – .276"	6–7
04225-08	.276 – .315"	7–8
04225-09	.315 – .354"	8–9
04225-10	.354 – .394"	9–10
04225-11	.394 – .433"	10–11
04225-12	.433 – .472"	11–12
04225-13	.472 – .512"	12–13
04225-14	.512 – .551"	13–14
04225-15	.551 – .591"	14–15
04225-16	.591 – .630"	15–16
04225-17	.630 – .669"	16–17

Use the table (below) for selecting your replacement collets. ER collets all have unique length and diameter measurements.

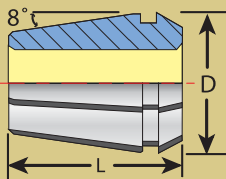

Size	L	D
ER8	13mm (.51")	8.5mm (.33")
ER11	18mm (.708")	11.5mm (.45")
ER16	27.5mm (1.08")	17mm (0.67")
ER20	31.5mm (1.24")	21mm (0.83")
ER25	34mm (1.34")	26mm (1.02")
ER32	40mm (1.57")	33mm (1.3")
ER40	46mm (1.81")	41mm (1.61")
ER50	60mm (2.36")	52mm (2.05")

ER32 Precision Metric Collets

Part No.	Inch Range	Shank mm
04232-03	.079 – .118"	2–3
04232-03.5	.098 – .137"	2.5–3.5
04232-04	.118 – .157"	3–4
04232-04.5	.137 – .177"	3.5–4.5
04232-05	.157 – .197"	4–5
04232-05.5	.177 – .216"	4.5–5.5
04232-06	.197 – .236"	5–6
04232-06.5	.216 – .255"	5.5–6.5
04232-07	.236 – .276"	6–7
04232-07.5	.255 – .295"	6.5–7.5
04232-08	.276 – .315"	7–8
04232-08.5	.295 – .334"	7.5–8.5
04232-09	.315 – .354"	8–9
04232-09.5	.334 – .374"	8.5–9.5
04232-10	.354 – .394"	9–10
04232-10.5	.374 – .413"	9.5–10.5
04232-11	.394 – .433"	10–11
04232-11.5	.413 – .452"	10.5–11.5
04232-12	.433 – .472"	11–12
04232-12.5	.452 – .492"	11.5–12.5
04232-13	.472 – .512"	12–13
04232-13.5	.492 – .531"	12.5–13.5
04232-14	.512 – .551"	13–14
04232-14.5	.531 – .570"	13.5–14.5
04232-15	.551 – .591"	14–15
04232-15.5	.570 – .610"	14.5–15.5
04232-16	.591 – .630"	15–16
04232-16.5	.610" – .649"	15.5–16.5
04232-17	.630 – .669"	16–17
04232-17.5	.649 – .688"	16.5–17.5
04232-18	.669 – .709"	17–18
04232-18.5	.688 – .728"	17.5–18.5
04232-19	.709 – .748"	18–19
04232-19.5	.728 – .767"	18.5–19.5
04232-20	.748 – .787"	19–20
04232-21	.787 – .827"	20–21

ER40 Precision Metric Collets

Part No.	Inch Range	Shank mm
04240-04	.118 – .157"	3–4
04240-05	.157 – .197"	4–5
04240-06	.197 – .236"	5–6
04240-07	.236 – .276"	6–7
04240-08	.276 – .315"	7–8
04240-09	.315 – .354"	8–9
04240-10	.354 – .394"	9–10
04240-11	.394 – .433"	10–11
04240-12	.433 – .472"	11–12
04240-13	.472 – .512"	12–13
04240-14	.512 – .551"	13–14
04240-15	.551 – .591"	14–15
04240-16	.591 – .630"	15–16
04240-17	.630 – .669"	16–17
04240-18	.669 – .709"	17–18
04240-19	.709 – .748"	18–19
04240-20	.748 – .787"	19–20
04240-21	.787 – .827"	20–21
04240-22	.827 – .866"	21–22
04240-23	.866 – .906"	22–23
04240-24	.906 – .945"	23–24
04240-25	.945 – .984"	24–25
04240-26	.984 – 1.024"	25–26

ER50 Precision Metric Collets

Part No.	Inch Range	Shank mm
04250-06	.197 – .236"	5–6
04250-07	.236 – .276"	6–7
04250-08	.276 – .315"	7–8
04250-09	.315 – .354"	8–9
04250-10	.354 – .394"	9–10
04250-12	.394 – .472"	10–12
04250-14	.472 – .551"	12–14
04250-16	.551 – .630"	14–16
04250-18	.630 – .709"	16–18
04250-20	.709 – .787"	18–20
04250-22	.787 – .866"	20–22
04250-24	.866 – .945"	22–24
04250-26	.945 – 1.024"	24–26
04250-28	1.024 – 1.102"	26–28
04250-30	1.102 – 1.181"	28–30
04250-32	1.181 – 1.259"	30–32
04250-34	1.259 – 1.338"	32–34

DNA – Dead Nuts Accurate Collets For Small Size Tools

DNA Collets Features

- .0002" T.I.R. extends cutting tool life!
- Best collet for tools 1/8" (6mm) and smaller
- More rigid and more accurate than ER, but works with your ER holders



DNA 11 Dead Nuts Accurate Collets

Part No.	Shank Size inch/mm	Range inch /mm
05952-02	5/64" / 1.5 - 2mm	.059" - .079" / .5mm
05952-03	7/64" / 2.5 - 3mm	.098" - .118" / .5mm
05952-03.5	1/8" / 3 - 3.5mm	.118" - .138" / .5mm
05952-04	5/32" / 3.5 - 4mm	.138" - .157" / .5mm
05952-05	3/16" / 4.5 - 5mm	.177" - .197" / .5mm
05952-06	15/64" / 5.5 - 6mm	.216" - .236" / .5mm
05952-1/8	exact size collet: 1/8"	.105" - .125" / .5mm
05952-3/16	exact size collet: 3/16"	.167" - .187" / .5mm
05952-1/4	exact size collet: 1/4"	.230" - .250" / .5mm
2011.0000	DNA 11 nut M14 x .75"	
04608	DNA 11 collet wrench	
DNA11TWA	DNA 11 torque wrench adapter	

ER Collet **DNA Collet**

DNA collets hold small tools with greater rigidity and more accuracy (T.I.R.) for greatly improved tool life.

DNA 16 Dead Nuts Accurate Collets

Part No.	Shank Size inch/mm	Range inch/mm
05954-0.3	.2 - .3mm	.007" - .011" / .10mm
05954-0.4	1/64" / .3 - .4mm	.011" - .015" / .10mm
05954-0.5	.4 - .5mm	.015" - .019" / .10mm
05954-0.6	.5 - .6mm	.019" - .023" / .10mm
05954-0.8	1/32" / .7 - .8mm	.027" - .031" / .10mm
05954-1.0	.9 - 1.0mm	.035" - .039" / .10mm
05954-1.2	3/64" / 1.1 - 1.2mm	.043" - .047" / .10mm
05954-1.25	1.0 - 1.25mm	.039" - .049" / .25mm
05954-1.5	1.25 - 1.5mm	.049" - .059" / .25mm
05954-1.75	1/16" / 1.5 - 1.75mm	.059" - .068" / .25mm
05954-02	5/64" / 1.75 - 2mm	.068" - .078" / .25mm
05954-2.25	2 - 2.25mm	.078" - .088" / .25mm
05954-2.5	3/32" / 2.25 - 2.5mm	.088" - .098" / .25mm
05954-03	2.5 - 3mm	.098" - .118" / .5mm
05954-3.5	1/8" / 3 - 3.5mm	.118" - .138" / .5mm
05954-04	5/32" / 3.5 - 4mm	.137" - .157" / .5mm
05954-4.5	4 - 4.5mm	.157" - .177" / .5mm
05954-05	3/16" / 4 - 5mm	.157" - .197" / .25mm
05954-06	7/32" / 5 - 6mm	.196" - .236" / 1.0mm
05954-07	1/4" / 6 - 7mm	.236" - .275" / 1.0mm
05954-08	5/16" / 7 - 8mm	.275" - .314" / 1.0mm
05954-09	11/32" / 8 - 9mm	.314" - .354" / 1.0mm
05954-10	3/8" / 9 - 10mm	.354" - .392" / 1.0mm
05954-1/8	exact size collet: 1/8"	.105" - .125" / .5mm
05954-3/16	exact size collet: 3/16"	.147" - .187" / 1.0mm
05954-1/4	exact size collet: 1/4"	.210" - .25" / 1.0mm
05954-3/8	exact size collet: 3/8"	.335 - .375" / 1.0mm

For Best Results Use DNA Collets & Nuts



DNA 16 Nut

Coolant Nut for 1/8" and 3mm

DNA Sealed Nut



Coolant Rings
pg. 64



Retention Knobs
pg. 200



Wrenches
pg. 204

DNA nuts feature PowerCOAT for 75% more holding power and best tool life.

DNA 16 Nuts, Sealed Nuts, Wrenches and TWAs

Part No.	Description
2016-2000	DNA16 Mini Nut - M19 x 1.0" x O.D. 25mm
27116	M22 x 1.5 nut, , O.D. 27mm
27216	M22 x 1.5 nut* 1/8" o-ring
27116-30	3.0 - 2.5mm sealed nut, O.D. 27mm
27116-40	4.0 - 3.5mm sealed nut, O.D. 27mm
27116-45	4.5 - 4.0mm sealed nut, O.D. 27mm
27116-50	5.0 - 4.5mm sealed nut, O.D. 27mm
27116-55	5.5 - 5mm sealed nut, O.D. 27mm
27116-60	6.0 - 5.5mm sealed nut, O.D. 27mm
27116-65	6.5 - 6mm sealed nut, O.D. 27mm
DNA16W	DNA 16 collet wrench
DNA16TWA	DNA 16 torque wrench adapter
894-22	DNA 16 mini nut wrench

DNA 20 Dead Nuts Accurate Collets

Part No.	Shank Size inch/mm	Range inch/mm
05956-03	2.5 - 3mm	.098" - .118" / .5mm
05956-3.5	1/8" / 3 - 3.5mm	.118" - .138" / .5mm
05956-04	5/32" / 3.5 - 4mm	.137" - .157" / .5mm
05956-05	3/16" / 4 - 5mm	.157" - .197" / 1.0mm
05956-06	7/32" 5 - 6mm	.197" - .236" / 1.0mm
05956-1/8	exact size collet: 1/8"	.105" - .125" / .5mm
05956-3/16	exact size collet: 3/16"	.147" - .187" / 1.0mm
05956-1/4	exact size collet: 1/4"	.210" - .250" / 1.0mm
05956-3/8	exact size collet: 3/8"	.335" - .375" / 1.0mm
2020.0000	DNA 20 nut, M25 x 1.5" x O.D. 32mm	
2020.0000C	DNA 20 coolant nut, uses ER20 rings on page 64	
DNA20W	DNA 20 collet wrench	
DNA20TWA	DNA 20 torque wrench adapter	

DNA 32 Dead Nuts Accurate Collets

Part No.	Shank Size inch/mm	Range inch/mm
05958-03	2.5 - 3mm	.098" - .118" / .5mm
05958-3.5	1/8" / 3 - 3.5mm	.118" - .138" / .5mm
05958-04	5/32" / 3.5 - 4mm	.137" - .157" / .5mm
05958-05	3/16" / 4 - 5mm	.157" - .197" / 1.0mm
05958-06	7/32" 5 - 6mm	.197" - .236" / 1.0mm
05958-1/8	exact size collet: 1/8"	.105" - .125" / .5mm
05958-3/16	exact size collet: 3/16"	.147" - .187" / 1.0mm
05958-1/4	exact size collet: 1/4"	.210" - .250" / 1.0mm
05958-3/8	exact size collet: 3/8"	.335" - .375" / 1.0mm
05958-1/2	exact size collet: 1/2"	.5"
05958-3/4	exact size collet: 3/4"	.75"
05958-13	exact size collet: 13mm	13mm
05958-20	exact size collet: 20mm	20 mm
1132.0000	DNA 32 nut, M40 x 1.5" x O.D. 47.5mm	
1132.0000C	DNA 32 coolant nut, uses ER25 rings on page 64	
DNA32W	DNA 32 collet wrench	
DNA32TWA	DNA 32 torque wrench adapter	

Steel Sealed Precision ER Coolant Collets – Inch Size



Features

- Sealed to 2000 PSI
- No plugs
- Protects toolholder from contaminants
- Use with ER PowerCOAT nuts (page 62)

Designed for use with on-size tools.

Use with ER, RD, DR, ESX or BR collet chucks.



Nuts
pg. 62



Coolant
Rings
pg. 64



Retention
Knobs
pg. 200



Wrenches
pg. 204

ER Inch Size Collet Sets

Part No.	Size	Pcs.	Fits Shank Sizes
04543IS	ER16	10	3/32 - 3/8"
04544IS	ER20	12	5/32 - 1/2"
04545IS	ER25	14	7/32 - 5/8"
04546IS	ER32	18	7/32 - 3/4"
04547IS	ER40	15	3/8 - 1.0"

ER16 Inch Size

Part No.	Shank
04543-3/32	3/32"
04543-1/8	1/8"
04543-5/32	5/32"
04543-3/16	3/16"
04543-7/32	7/32"
04543-1/4	1/4"
04543-9/32	9/32"
04543-5/16	5/16"
04543-11/32	11/32"
04543-3/8	3/8"
04543-13/32	13/32"

ER20 Inch Size

Part No.	Shank
04544-1/8	1/8"
04544-5/32	5/32"
04544-3/16	3/16"
04544-7/32	7/32"
04544-1/4	1/4"
04544-9/32	9/32"
04544-5/16	5/16"
04544-11/32	11/32"
04544-3/8	3/8"
04544-13/32	13/32"
04544-7/16	7/16"
04544-15/32	15/32"
04544-1/2	1/2"

ER25 Inch Size

Part No.	Shank
04545-7/32	7/32"
04545-1/4	1/4"
04545-9/32	9/32"
04545-5/16	5/16"
04545-11/32	11/32"
04545-3/8	3/8"
04545-13/32	13/32"
04545-7/16	7/16"
04545-15/32	15/32"
04545-1/2	1/2"
04545-17/32	17/32"
04545-9/16	9/16"
04545-19/32	19/32"
04545-5/8	5/8"

ER32 Inch Size

Part No.	Shank
04546-7/32	7/32"
04546-1/4	1/4"
04546-9/32	9/32"
04546-5/16	5/16"
04546-11/32	11/32"
04546-3/8	3/8"
04546-13/32	13/32"
04546-7/16	7/16"
04546-15/32	15/32"
04546-1/2	1/2"
04546-17/32	17/32"
04546-9/16	9/16"
04546-19/32	19/32"
04546-5/8	5/8"
04546-21/32	21/32"
04546-11/16	11/16"
04546-23/32	23/32"
04546-3/4	3/4"

ER40 Inch Size

Part No.	Shank
04547-3/8	3/8"
04547-13/32	13/32"
04547-7/16	7/16"
04547-15/32	15/32"
04547-1/2	1/2"
04547-17/32	17/32"
04547-9/16	9/16"
04547-19/32	19/32"
04547-5/8	5/8"
04547-21/32	21/32"
04547-11/16	11/16"
04547-23/32	23/32"
04547-3/4	3/4"
04547-7/8	7/8"
04547-1	1.0"

Steel Sealed Precision ER Coolant Collets – Metric Size



Features

- Sealed to 2000 PSI
- No plugs
- Protects toolholder from contaminants
- Use with ER PowerCOAT nuts (page 62)

Designed for use with on-size tools.

Use with ER, RD, DR, ESX or BR collet chucks.



ER Metric Size Collet Sets

Part No.	Size	Pcs.	Fits Shank Sizes
04543MS	ER16	8	3 - 10mm
04544MS	ER20	11	3 - 13mm
04545MS	ER25	14	3 - 16mm
04546MS	ER32	18	3 - 20mm

ER16 Metric Size

Part No.	Shank
04543-03	3mm
04543-04	4mm
04543-05	5mm
04543-06	6mm
04543-07	7mm
04543-08	8mm
04543-09	9mm
04543-10	10mm

ER20 Metric Size

Part No.	Shank
04544-03	3mm
04544-04	4mm
04544-05	5mm
04544-06	6mm
04544-07	7mm
04544-08	8mm
04544-09	9mm
04544-10	10mm
04544-11	11mm
04544-12	12mm
04544-13	13mm

ER25 Metric Size

Part No.	Shank
04545-03	3mm
04545-04	4mm
04545-05	5mm
04545-06	6mm
04545-07	7mm
04545-08	8mm
04545-09	9mm
04545-10	10mm
04545-11	11mm
04545-12	12mm
04545-13	13mm
04545-14	14mm
04545-15	15mm
04545-16	16mm

ER32 Metric Size

Part No.	Shank
04546-03	3mm
04546-04	4mm
04546-05	5mm
04546-06	6mm
04546-07	7mm
04546-08	8mm
04546-09	9mm
04546-10	10mm
04546-11	11mm
04546-12	12mm
04546-13	13mm
04546-14	14mm
04546-15	15mm
04546-16	16mm
04546-17	17mm
04546-18	18mm
04546-19	19mm
04546-20	20mm

ER40 Metric Size

Part No.	Shank
04547-06	6mm
04547-07	7mm
04547-08	8mm
04547-09	9mm
04547-10	10mm
04547-11	11mm
04547-12	12mm
04547-13	13mm
04547-14	14mm
04547-15	15mm
04547-16	16mm
04547-17	17mm
04547-18	18mm
04547-19	19mm
04547-20	20mm
04547-25	25mm

Precision ER Sealed Metric Coolant Collets



Features

- Larger plugs for 750 PSI coolant
- Use with ER PowerCOAT nuts (page 62)
- Exclusive design reduces points of failure 50%

Use with ER, RD, DR, ESX or BR collet chucks.

Other inch sizes available from stock in ER16 & ER20.

ER16 Sealed Collets

Part No.	Shank
08316-03.0	3mm
08316-03.5	3.5mm
08316-04.0	4mm
08316-04.5	4.5mm
08316-05.0	5mm
08316-05.5	5.5mm
08316-06.0	6mm
08316-1/4	1/4"
08316-06.5	6.5mm
08316-07.0	7mm
08316-07.5	7.5mm
08316-08.0	8mm
08316-08.5	8.5mm
08316-09.0	9mm
08316-09.5	9.5mm
08316-10.0	10mm

ER20 Sealed Collets

Part No.	Shank
08320-03.0	3mm
08320-03.5	3.5mm
08320-04.0	4mm
08320-04.5	4.5mm
08320-05.0	5mm
08320-05.5	5.5mm
08320-06.0	6mm
08320-1/4	1/4"
08320-06.5	6.5mm
08320-07.0	7mm
08320-07.5	7.5mm
08320-08.0	8mm
08320-08.5	8.5mm
08320-09.0	9mm
08320-09.5	9.5mm
08320-10.0	10mm
08320-10.5	10.5mm
08320-11.0	11mm
08320-11.5	11.5mm
08320-12.0	12mm
08320-12.5	12.5mm
08320-1/2	1/2"
08320-13.0	13mm

Sealed Collet Sets

Part No.	Description
08316MS	15 pcs. ER16
08320MS	21 pcs ER20
08325MS	27 pcs ER25
08332-35MS	35 pcs ER32
08340-41MS	41 pcs ER40

ER25 Sealed Collets

Part No.	Shank
08325-03.0	3mm
08325-03.5	3.5mm
08325-04.0	4mm
08325-04.5	4.5mm
08325-05.0	5mm
08325-05.5	5.5mm
08325-06.0	6mm
08325-1/4	1/4"
08325-06.5	6.5mm
08325-07.0	7mm
08325-07.5	7.5mm
08325-08.0	8mm
08325-08.5	8.5mm
08325-09.0	9mm
08325-09.5	9.5mm
08325-10.0	10mm
08325-10.5	10.5mm
08325-11.0	11mm
08325-11.5	11.5mm
08325-12.0	12mm
08325-12.5	12.5mm
08325-1/2	1/2"
08325-13.0	13mm
08325-13.5	13.5mm
08325-14.0	14mm
08325-14.5	14.5mm
08325-15.0	15mm
08325-15.5	15.5mm
08325-16.0	16mm

ER32 Sealed Collets

Part No.	Shank
08332-03.0	3mm
08332-03.5	3.5mm
08332-04.0	4mm
08332-04.5	4.5mm
08332-05.0	5mm
08332-05.5	5.5mm
08332-06.0	6mm
08332-1/4	1/4"
08332-06.5	6.5mm
08332-07.0	7mm
08332-07.5	7.5mm
08332-08.0	8mm
08332-08.5	8.5mm
08332-09.0	9mm
08332-09.5	9.5mm
08332-10.0	10mm
08332-10.5	10.5mm
08332-11.0	11mm
08332-11.5	11.5mm
08332-12.0	12mm
08332-12.5	12.5mm
08332-1/2	1/2"
08332-13.0	13mm
08332-13.5	13.5mm
08332-14.0	14mm
08332-14.5	14.5mm
08332-15.0	15mm
08332-15.5	15.5mm
08332-16.0	16mm
08332-16.5	16.5mm
08332-17.0	17mm
08332-17.5	17.5mm
08332-18.0	18mm
08332-18.5	18.5mm
08332-19	19mm
08332-3/4	3/4"
08332-19.5	19.5mm
08332-20.0	20mm

ER40 Sealed Collets

Part No.	Shank
08340-06.0	6mm
08340-1/4	1/4"
08340-06.5	6.5mm
08340-07.0	7mm
08340-07.5	7.5mm
08340-08.0	8mm
08340-08.5	8.5mm
08340-09.0	9mm
08340-09.5	9.5mm
08340-10.0	10mm
08340-10.5	10.5mm
08340-11.0	11mm
08340-11.5	11.5mm
08340-12.0	12mm
08340-12.5	12.5mm
08340-1/2	1/2"
08340-13.0	13mm
08340-13.5	13.5mm
08340-14.0	14mm
08340-14.5	14.5mm
08340-15.0	15mm
08340-15.5	15.5mm
08340-16.0	16mm
08340-16.5	16.5mm
08340-17.0	17mm
08340-17.5	17.5mm
08340-18.0	18mm
08340-18.5	18.5mm
08340-19.0	19mm
08340-3/4	3/4"
08340-19.5	19.5mm
08340-20.0	20mm
08340-20.5	20.5mm
08340-21.0	21mm
08340-21.5	21.5mm
08340-22.0	22mm
08340-22.5	22.5mm
08340-23.0	23mm
08340-23.5	23.5mm
08340-24.0	24mm
08340-24.5	24.5mm
08340-25.0	25mm
08340-25.5	25.5mm
08340-26.0	26mm
08340-1	25.4mm

Precision ER Floating Tap Collets and Collet Sets



Features

- Axial compensation prevents breaking taps
- Replaces expensive tapping heads
- Locking feature prevents spinning the tap
- Reduce tapping clearance requirements

Compatible with these standard collet chucks:
ER, DR, RD, ESX, BR or DIN 6499 collet pockets.



Nuts
pg. 62



Coolant
Rings
pg. 64



Retention
Knobs
pg. 200



Wrenches
pg. 204

Applications: CNC lathes, VDI turrets, angle heads, CNC machine center, swiss style turning machines, and driven heads on CNC lathe turrets.

Simply program the machine 5% behind the recommended pitch feed of the tap to make the floating collet work. Return out of the tapped hole at 100%.

For best performance use FT tap collets with Techniks PowerCOAT nut.
See page 62.

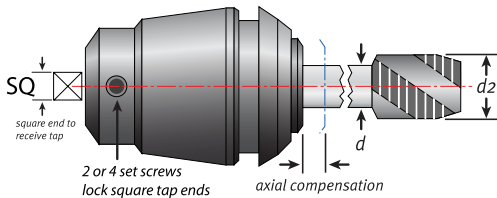

FT Collet Sets

Part No.	Description
05916IS	4 piece collet set
05920IS	5 piece collet set
05925IS	9 piece collet set
05932IS	11 piece collet set

FT-116 Floating Tap Collets

Part No.	d	SQ	Size (d2)
05916-141	.141"	.110"	1/8" or #6
05916-168	.168"	.131"	5/32" or #8
05916-194	.194"	.152"	3/16" or #10
05916-220	.220"	.165"	7/32" or #12

axial compensation = 7mm

FT-120 Floating Tap Collets

Part No.	d	SQ	Size (d2)
05920-141	.141"	.110"	1/8" or #6
05920-168	.168"	.131"	5/32" or #8
05920-194	.194"	.152"	3/16" or #10
05920-220	.220"	.165"	7/32" or #12
05920-255	.255"	.191"	1/4"

axial compensation = 7mm

FT-125 Floating Tap Collets

Part No.	d	SQ	Size (d2)
05925-141	.141"	.110"	1/8" or #6
05925-168	.168"	.131"	5/32" or #8
05925-194	.194"	.152"	3/16" or #10
05925-220	.220"	.165"	7/32" or #12
05925-255	.255"	.191"	1/4"
05925-318	.318"	.238"	5/16"
05925-323	.323"	.242"	7/16"
05925-367	.367"	.275"	1/2"
05925-381	.381"	.286"	3/8"

axial compensation = 8mm

FT-132 Floating Tap Collets

Part No.	d	SQ	Size (d2)
05932-168	.168"	.131"	5/32" or #8
05932-194	.194"	.152"	3/16" or #10
05932-220	.220"	.165"	7/32" or #12
05932-255	.255"	.191"	1/4"
05932-318	.318"	.238"	5/16"
05932-323	.323"	.242"	7/16"
05932-367	.367"	.275"	1/2"
05932-381	.381"	.286"	3/8"
05932-429	.429"	.322"	9/16"
05932-437	.437"	.328"	1/8" NPT
05932-480	.480"	.360"	5/8"

axial compensation = 10mm

Precision ER Rigid Tap Collets Inch Sizes



Features

- Replaces expensive tap holders
- Reduce tapping clearance requirements
- Special design locks square in slots

Compatible with ER, DR, RD, ESX, BR or DIN 6499 collet pockets.

For best results use with a PowerCOAT nut to increase clamping pressure up to 75%. See page 62.

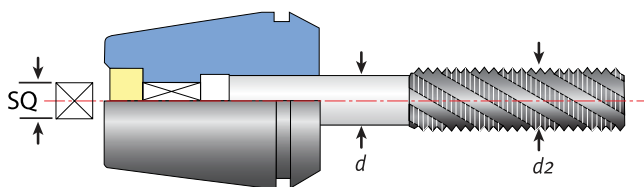

Rigid Tap Collet Sets

Part No.	Description
05320-5(SET)	5 piece ER16 set
05320-9(SET)	9 piece ER16 set
05410-9(SET)	9 piece ER20 set
05510-11(SET)	11 piece ER25 set
05570-16(SET)	16 piece ER32 set
05710-21(SET)	21 piece ER40 set

ER16 Rigid Tap Collets

Part No.	d	SQ	Tap Size (d2)
05320-141	.141"	.110"	1/8" or #6
05320-168	.168"	.131"	5/32" or #8
05320-194	.194"	.152"	3/16" or #10
05320-220	.220"	.165"	7/32" or #12
05320-255	.255"	.191"	1/4"
05320-318	.318"	.238"	5/16"
05320-323	.323"	.242"	7/16"
05320-367	.367"	.275"	1/2"
05320-381	.381"	.286"	3/8"

ER20 Rigid Tap Collets

Part No.	d	SQ	Tap Size (d2)
05410-141	.141"	.110"	1/8" or #6
05410-168	.168"	.131"	5/32" or #8
05410-194	.194"	.152"	3/16" or #10
05410-220	.220"	.165"	7/32" or #12
05410-255	.255"	.191"	1/4"
05410-318	.318"	.238"	5/16"
05410-323	.323"	.242"	7/16"
05410-367	.367"	.275"	1/2"
05410-381	.381"	.286"	3/8"

ER25 Rigid Tap Collets

Part No.	d	SQ	Tap Size (d2)
05510-141	.141"	.110"	1/8" or #6
05510-168	.168"	.131"	5/32" or #8
05510-194	.194"	.152"	3/16" or #10
05510-220	.220"	.165"	7/32" or #12
05510-255	.255"	.191"	1/4"
05510-318	.318"	.238"	5/16"
05510-323	.323"	.242"	7/16"
05510-367	.367"	.275"	1/2"
05510-381	.381"	.286"	3/8"
05510-429	.429"	.322"	9/16"
05510-437	.437"	.328"	1/8" NPT
05510-480	.480"	.360"	5/8"
05510-542	.542"	.406"	11/16"

ER32 Rigid Tap Collets

Part No.	d	SQ	Tap Size (d2)
05570-141	.141"	.110"	1/8" or #6
05570-168	.168"	.131"	5/32" or #8
05570-194	.194"	.152"	3/16" or #10
05570-220	.220"	.165"	7/32" or #12
05570-255	.255"	.191"	1/4"
05570-318	.318"	.238"	5/16"
05570-323	.323"	.242"	7/16"
05570-367	.367"	.275"	1/2"
05570-381	.381"	.286"	3/8"
05570-429	.429"	.322"	9/16"
05570-437	.437"	.328"	1/8" NPT
05570-480	.480"	.360"	5/8"
05570-542	.542"	.406"	11/16"
05570-562	.562"	.421"	1/4" NPT
05570-590	.590"	.442"	3/4"
05570-652	.652"	.489"	13/16"

ER40 Rigid Tap Collets

Part No.	d	SQ	Tap Size (d2)
05710-141	.141"	.110"	1/8" or #6
05710-168	.168"	.131"	5/32" or #8
05710-194	.194"	.152"	3/16" or #10
05710-220	.220"	.165"	7/32" or #12
05710-255	.255"	.191"	1/4"
05710-318	.318"	.238"	5/16"
05710-323	.323"	.242"	7/16"
05710-367	.367"	.275"	1/2"
05710-381	.381"	.286"	3/8"
05710-429	.429"	.322"	9/16"
05710-437	.437"	.328"	1/8" NPT
05710-480	.480"	.360"	5/8"
05710-542	.542"	.406"	11/16"
05710-562	.562"	.421"	1/4" NPT
05710-590	.590"	.442"	3/4"
05710-652	.652"	.489"	13/16"
05710-687	.687"	.515"	1/2" NPT
05710-697	.697"	.523"	7/8"
05710-700	.700"	.531"	3/8" NPT
05710-760	.760"	.570"	15/16"
05710-800	.800"	.600"	1"

Precision ER Rigid Tap Collets Metric Sizes



Features

- Replaces expensive tap holders
- Reduce tapping clearance requirements
- Special design locks square in slots

Compatible with ER, DR, RD, ESX, BR or DIN 6499 collet pockets.

For best results use with a PowerCOAT nut to increase clamping pressure up to 75%. See page 62.



Nuts
pg. 62



Coolant
Rings
pg. 64



Retention
Knobs
pg. 200



Wrenches
pg. 204

ER16 Rigid Tap Collets

Part No.	d	SQ	Tap Size (d2)
05326-DIN	2.8	2.1	
05330-DIN	3.5	2.7	M3
05336-DIN	4.5	3.4	M4
05342-DIN	6	4.9	M5/M6
05350-DIN	8	6.2	M8
05352	8.5	6.5	M12
05354-DIN	9	7	M12
05356-DIN	10	8	M10
05371	6	4.5	M6
05385	6.2	5	M8

Dimensions in mm.

ER20 Rigid Tap Collets

Part No.	d	SQ	Tap Size (d2)
05428-DIN	4.5	3.4	M4
05434-DIN	6	4.9	M5/M6
05436	6.2	5	M7/M8
05442-DIN	8	6.2	M8
05446-DIN	9	7	M12
05448-DIN	10	8	M10
05456-DIN	12	9	M16

ER25 Rigid Tap Collets

Part No.	d	SQ	Tap Size (d2)
05526-DIN	4.5	3.4	M4
05534-DIN	6	4.9	M5/M6
05540-DIN	7	5.5	M10
05542-DIN	8	6.2	M8
05548-DIN	9	7	M12
05550	10	8	M10
05550-DIN	10	8	M10
05554-DIN	11	9	M14
05558-DIN	12	9	M16

Dimensions in mm.

ER32 Rigid Tap Collets

Part No.	d	SQ	Tap Size (d2)
05586-DIN	4.5	3.4	M4
05598-M9	7	5.5	M9
05600-DIN	8	6.2	M8
05600-JIS	8	6	M11
05604-DIN	9	7	M12
05606-DIN	10	8	M10
05610	11	9	M14
05614-DIN	12	9	M16
05620-DIN	14	11	M18
05624-DIN	16	12	M20
05633	20	15	M27

Dimensions in mm.

Precision ER Quick-Change Rigid Tap Collets



Features

- Quick-Change taps in seconds
- Replaces expensive tap holders
- Locking feature prevents spinning the tap
- Reduce tapping clearance requirements

Compatible with these standard collet chucks:
ER, DR, RD, ESX, BR or DIN 6499 collet pockets.

For best tapping performance use with Techniks PowerCOAT nut for highest holding power and accuracy. See page 62.

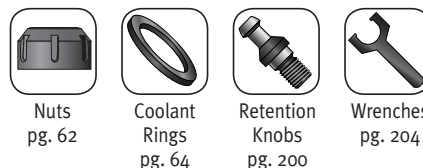
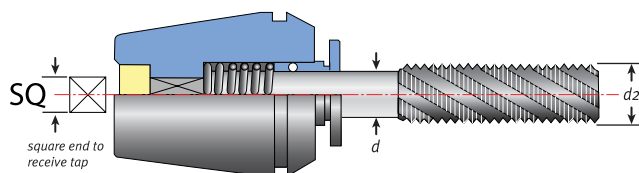

Nuts
pg. 62

Coolant
Rings
pg. 64

Retention
Knobs
pg. 200

Wrenches
pg. 204

Quick-Change Tap Collet Sets

Part No.	Description
05802-4(SET)	4 piece collet set
05804-8(SET)	8 piece collet set
0580611IS	11 piece collet set
05808-15(SET)	15 piece collet set

ER16 Quick-Change Rigid Tap

Part No.	d	SQ	Tap Size (d2)
05802-168	.168"	.131"	5/32" or #8
05802-194	.194"	.152"	3/16" or #10
05802-220	.220"	.165"	7/32" or #12
05802-255	.255"	.191"	1/4"

ER20 Quick-Change Rigid Tap

Part No.	d	SQ	Tap Size (d2)
05804-168	.168"	.131"	5/32" or #8
05804-194	.194"	.152"	3/16" or #10
05804-220	.220"	.165"	7/32" or #12
05804-255	.255"	.191"	1/4"
05804-318	.318"	.238"	5/16"
05804-323	.323"	.242"	7/16"
05804-367	.367"	.275"	1/2"
05804-381	.381"	.286"	3/8"

ER25 Quick-Change Rigid Tap

Part No.	d	SQ	Tap Size (d2)
05806-168	.168"	.131"	5/32" or #8
05806-194	.194"	.152"	3/16" or #10
05806-220	.220"	.165"	7/32" or #12
05806-255	.255"	.191"	1/4"
05806-318	.318"	.238"	5/16"
05806-323	.323"	.242"	7/16"
05806-367	.367"	.275"	1/2"
05806-381	.381"	.286"	3/8"
05806-429	.429"	.322"	9/16"
05806-437	.437"	.328"	1/8" NPT
05806-480	.480"	.360"	5/8"

ER32 Quick-Change Rigid Tap

Part No.	d	SQ	Tap Size (d2)
05808-168	.168"	.131"	5/32" or #8
05808-194	.194"	.152"	3/16" or #10
05808-220	.220"	.165"	7/32" or #12
05808-255	.255"	.191"	1/4"
05808-318	.318"	.238"	5/16"
05808-323	.323"	.242"	7/16"
05808-367	.367"	.275"	1/2"
05808-381	.381"	.286"	3/8"
05808-429	.429"	.322"	9/16"
05808-437	.437"	.328"	1/8" NPT
05808-480	.480"	.360"	5/8"
05808-542	.542"	.406"	11/16"
05808-562	.562"	.421"	1/4" NPT
05808-590	.590"	.442"	3/4"
05808-652	.652"	.489"	13/16"

Collet Storage Trays



Features

- Prevent accidental damage to collets
- Keep collets organized and ready to use
- Exact fit for all your collets

ER Collet Storage Trays

Part No.	Description
04282	ER8 wood Tray - 9 pcs.
04284	ER11 wood tray - 13 pcs.
04286	ER16 wood tray - 10 pcs.
04286-12	ER16 wood tray - 12 pcs.
04288	ER20 wood tray - 12 pcs.
04290	ER25 wood tray - 16 pcs.
04292	ER32 wood tray - 18 pcs.
04292-22	ER32 wood tray - 22 pcs.
04294	ER40 wood tray - 24 pcs.
04294-13	ER40 wood tray - 13 pcs.
04296	ER50 wood tray - 12 pcs.

DA Collet Storage Trays

Part No.	Description
04448	DA100 wood tray - 33 pcs
04449	DA100 wood tray - 8 pcs.
04450	DA100 wood tray - 15 pcs.
04451	DA100 wood tray - 21 pcs.
04452	DA100 wood tray - 29 pcs.
04453	DA180 wood tray - 9 pcs.
04454	DA180 wood tray - 17 pcs.
04455	DA180 wood tray - 21 pcs.
04456	DA180 wood tray - 33 pcs.
04457	DA180 wood tray - 41 pcs.
04459	DA200 wood tray - 9 pcs.
04460	DA200 wood tray - 21 pcs.
04461	DA200 wood tray - 17 pcs.
04462	DA300 wood tray - 7 pcs.
04464	DA300 wood tray - 14 pcs.

TG Collet Storage Trays

Part No.	Description
04466	TG75 wood tray - 11 pcs.
04468	TG75 wood tray - 22 pcs.
04470	TG75 wood tray - 43 pcs.
04472	TG100 wood tray - 15 pcs.
04474	TG100 wood tray - 21 pcs.
04476	TG100 wood tray - 30 pcs.
04478	TG100 wood tray - 41 pcs.
04480	TG100 wood tray - 59 pcs.
04482	TG150 wood tray - 17 pcs.
04484	TG150 wood tray - 33 pcs.
04486	TG150 wood tray - 65 pcs.

PowerCOAT ER Collet Nuts and Coolant Nuts



Features

- Increases holding power by 75%
- Balanced to 25,000 RPM
- Better rigidity and T.I.R. (runout)

See Torque Chart on page 72.

PowerCOAT ER Collet Nuts

Part No.	Description	D	B	T	Wrench
41111	ER11 PowerCOAT hex nut	19mm	12mm	M14 x 0.75	04608
41116	ER16 PowerCOAT hex nut	27.5mm	18mm	M22 x 1.5	04609
41120	ER20 PowerCOAT hex nut	34mm	19mm	M25 x 1.5	04610
41916	ER16 PowerCOAT slot nut	32mm	18mm	M22 x 1.5	04613
41920	ER20 PowerCOAT slot nut	35mm	19.5mm	M25 x 1.5	04614
41925	ER25 PowerCOAT slot nut	42mm	21mm	M32 x 1.5	04615
41932	ER32 PowerCOAT slot nut	50mm	23mm	M40 x 1.5	04616
41940	ER40 PowerCOAT slot nut	63mm	26mm	M50 x 1.5	04617
41950	ER50 PowerCOAT slot nut	78mm	35mm	M64 x 2.0	04618

PowerCOAT Ultra High-Speed ER Nuts (balanced up to 70,000 RPM)

Part No.	Description	D	B	T	Wrench
46111	ER11 high speed hex nut	19mm	11.8mm	M14 x 0.75	04608
46116	ER16 high speed slot nut	27.5mm	18.0mm	M22 x 1.5	04613
46120	ER20 high speed slot nut	35mm	19.5mm	M25 x 1.5	04614
46125	ER25 high speed slot nut	42mm	20.5mm	M32 x 1.5	04615
46132	ER32 high speed slot nut	50mm	23.0mm	M40 x 1.5	04616
46140	ER40 high speed slot nut	63mm	26.0mm	M50 x 1.5	04617



Features

- Increases holding power by 75%
- Seals up to 1,500 P.S.I.
- Balanced to 25,000 RPM
- Use with coolant rings pg. 64

PowerCOAT ER Coolant Nuts

Part No.	Description	D	B	T	Wrench
41616	ER16 coolant slot nut	32	22.5	M22x1.5	04613
41620	ER20 coolant slot nut	35	24	M25x1.5	04614
41625	ER25 coolant slot nut	42	25	M32x1.5	04615
41632	ER32 coolant slot nut	50	27.5	M40x1.5	04616
41640	ER40 coolant slot nut	63	30.7	M50x1.5	04617

Holding Power Testing – ft/lbs

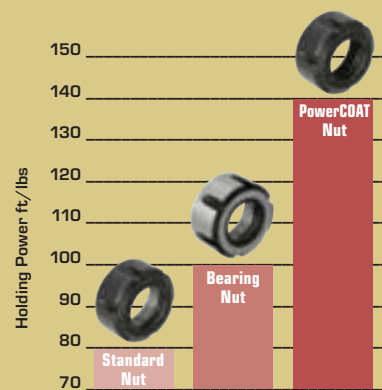

Each nut was tightened to 70 ft/lbs recommended torque before break-free testing of holding power.

Watch the Holding Power testing video at:

www.techniksusa.com/pcnut

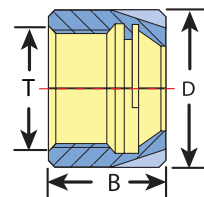

For best performance use a torque wrench and tighten nut to proper torque specification. Snap collet into nut before assembly.

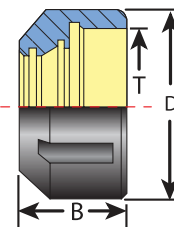

Coolant ring snaps into the nut to seal the tool shank. (pg. 64)
For coolant-thru tools.

PowerCOAT ER Mini Nuts and Bearing Nuts



ER Mini Nut

Features

- For minimum nose O.D. applications
- Increases holding power by 75%
- High speed nuts balanced to 20,000 RPM



Collets
pg. 48



Nuts
pg. 62



Coolant
Rings
pg. 64



Wrenches
pg. 204



Tightening
Stands
pg. 206

ER High Speed Mini Nuts (balanced to 20,000 RPM at G2.5)

Part No.	Description	D	B	T	Wrench
33108	ER8 high speed mini nut	12mm	11mm	M10 x 0.75	04620
33111	ER11 high speed mini nut	16mm	12mm	M13 x 0.75	04621
33116	ER16 high speed mini nut	22mm	18mm	M19 x 1.0	04622
33120	ER20 high speed mini nut	28mm	19.5mm	M24 x 1.0	04623
33125	ER25 high speed mini nut	35mm	21mm	M30 x 1.0	04624
33125-L	ER25 h.s. left-hand mini nut	35mm	21mm	M30 x 1.0	04624

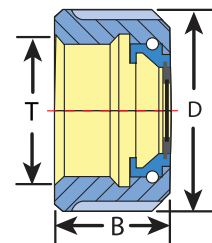

ER Mini Nuts (balanced to 10,000 RPM at G2.5)

Part No.	Description	D	B	T	Wrench
23108	ER8 mini nut	12mm	11mm	M10 x 0.75	04620
23111	ER11 mini nut	16mm	12mm	M13 x 0.75	04621
23116	ER16 mini nut	22mm	18mm	M19 x 1.0	04622
23120	ER20 mini nut	28mm	19.5mm	M24 x 1.0	04623
23125	ER25 mini nut	35mm	21mm	M30 x 1.0	04624

ER Mini Coolant Nuts (balanced to 10,000 RPM at G2.5)

Part No.	Description	Ring	D	B	T	Wrench
23616	ER16 mini coolant nut	ER16	22mm	24mm	M19 x 1.0	04622
23620	ER20 mini coolant nut	ER20	28mm	24mm	M24 x 1.0	04623
23625	ER25 mini coolant nut	ER25	35mm	26.5mm	M30 x 1.0	04624



Coolant Style Mini nut uses ER coolant rings (page 64)



Features

- Increases holding power by 75%
- Balanced to 18,000 RPMs
- Snap collet into nut before assembly

See Torque Chart on page 72.

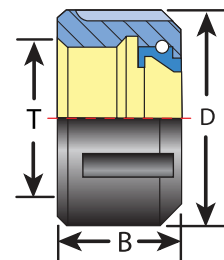

PowerCOAT Bearing Nuts

Part No.	Description	D	B	T	Wrench
29116	ER16 high speed bearing nut	27.5mm	18mm	M22x1.5	04609
29132	ER32 high speed bearing nut	50mm	25mm	M40x1.5	04616

Note: Use a torque wrench and tighten nut to proper torque specification. Do not over tighten these nuts. Snap collet into nut before assembly.

Black Gold ER Coolant Rings



Snap ring into nut before ER collet

Features

- Seals up to 1,500 P.S.I.
- Use with ER collets
- Use with PowerCOAT coolant nuts



PowerCOAT coolant nuts pg. 62

Black Gold ER16 Coolant Rings

Part No.	Shank mm	Shank inch
08516-03.5	3.5 – 3.0mm	1/8"
08516-04.0	4.0 – 3.5mm	5/32"
08516-04.5	4.5 – 4.0mm	11/64"
08516-05.0	5.0 – 4.5mm	3/16"
08516-05.5	5.5 – 5.0mm	13/64"
08516-06.0	6.0 – 5.5mm	7/32"
08516-06.5	6.5 – 6.0mm	1/4"
08516-07.0	7.0 – 6.5mm	17/64"
08516-07.5	7.5 – 7.0mm	9/32"
08516-08.0	8.0 – 7.5mm	5/16"
08516-08.5	8.5 – 8.0mm	21/64"
08516-09.0	9.0 – 8.5mm	11/32"
08516-09.5	9.5 – 9.0mm	3/8"
08516-10.0	10.0 – 9.5mm	25/64"

Black Gold ER20 Coolant Rings

Part No.	Shank mm	Shank inch
08520-03.5	3.5 – 3.0mm	1/8"
08520-04.0	4.0 – 3.5mm	5/32"
08520-04.5	4.5 – 4.0mm	11/64"
08520-05.0	5.0 – 4.5mm	3/16"
08520-05.5	5.5 – 5.0mm	13/64"
08520-06.0	6.0 – 5.5mm	7/32"
08520-06.5	6.5 – 6.0mm	1/4"
08520-07.0	7.0 – 6.5mm	17/64"
08520-07.5	7.5 – 7.0mm	9/32"
08520-08.0	8.0 – 7.5mm	5/16"
08520-08.5	8.5 – 8.0mm	21/64"
08520-09.0	9.0 – 8.5mm	11/32"
08520-09.5	9.5 – 9.0mm	3/8"
08520-10.0	10.0 – 9.5mm	25/64"
08520-10.5	10.5 – 10.0mm	13/32"
08520-11.0	11.0 – 10.5mm	27/64"
08520-11.5	11.5 – 11.0mm	7/16"
08520-12.0	12.0 – 11.5mm	15/32"
08520-12.5	12.5 – 12.0mm	31/64"
08520-13.0	13.0 – 12.5mm	1/2"

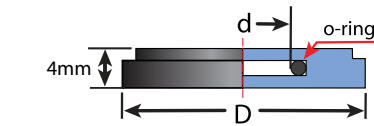

Dimensions	D
ER16	12.9 mm
ER20	15.9 mm
ER25	21 mm
ER32	26.95 mm
ER40	33.3 mm

Black Gold ER25 Coolant Rings

Part No.	Shank mm	Shank inch
08525-03.5	3.5 – 3.0mm	1/8"
08525-04.0	4.0 – 3.5mm	5/32"
08525-04.5	4.5 – 4.0mm	11/64"
08525-05.0	5.0 – 4.5mm	3/16"
08525-05.5	5.5 – 5.0mm	13/64"
08525-06.0	6.0 – 5.5mm	7/32"
08525-06.5	6.5 – 6.0mm	1/4"
08525-07.0	7.0 – 6.5mm	17/64"
08525-07.5	7.5 – 7.0mm	9/32"
08525-08.0	8.0 – 7.5mm	5/16"
08525-08.5	8.5 – 8.0mm	21/64"
08525-09.0	9.0 – 8.5mm	11/32"
08525-09.5	9.5 – 9.0mm	3/8"
08525-10.0	10.0 – 9.5mm	25/64"
08525-10.5	10.5 – 10.0mm	13/32"
08525-11.0	11.0 – 10.5mm	27/64"
08525-11.5	11.5 – 11.0mm	7/16"
08525-12.0	12.0 – 11.5mm	15/32"
08525-12.5	12.5 – 12.0mm	31/64"
08525-13.0	13.0 – 12.5mm	1/2"
08525-13.5	13.5 – 13.0mm	17/32"
08525-14.0	14.0 – 13.5mm	35/64"
08525-14.5	14.5 – 14.0mm	9/16"
08525-15.0	15.0 – 14.5mm	37/64"
08525-15.5	15.5 – 15.0mm	19/32"
08525-16.0	16.0 – 15.5mm	5/8"

NOTE: Remove o-ring for coolant surround tool applications using non-coolant cutting tools. (see photos pg. 53)

Black Gold ER32 TG100 Coolant Rings

Part No.	Shank mm	Shank inch
08532-03.5	3.5 – 3.0mm	1/8"
08532-04.0	4.0 – 3.5mm	5/32"
08532-04.5	4.5 – 4.0mm	11/64"
08532-05.0	5.0 – 4.5mm	3/16"
08532-05.5	5.5 – 5.0mm	13/64"
08532-06.0	6.0 – 5.5mm	7/32"
08532-06.5	6.5 – 6.0mm	1/4"
08532-07.0	7.0 – 6.5mm	17/64"
08532-07.5	7.5 – 7.0mm	9/32"
08532-08.0	8.0 – 7.5mm	5/16"
08532-08.5	8.5 – 8.0mm	21/64"
08532-09.0	9.0 – 8.5mm	11/32"
08532-09.5	9.5 – 9.0mm	3/8"
08532-10.0	10.0 – 9.5mm	25/64"
08532-10.5	10.5 – 10.0mm	13/32"
08532-11.0	11.0 – 10.5mm	27/64"
08532-11.5	11.5 – 11.0mm	7/16"
08532-12.0	12.0 – 11.5mm	15/32"
08532-12.5	12.5 – 12.0mm	31/64"
08532-13.0	13.0 – 12.5mm	1/2"
08532-13.5	13.5 – 13.0mm	17/32"
08532-14.0	14.0 – 13.5mm	35/64"
08532-14.5	14.5 – 14.0mm	9/16"
08532-15.0	15.0 – 14.5mm	37/64"
08532-15.5	15.5 – 15.0mm	19/32"
08532-16.0	16.0 – 15.5mm	5/8"
08532-16.5	16.5 – 16.0mm	41/64"
08532-17.0	17.0 – 16.5mm	21/32"
08532-17.5	17.5 – 17.0mm	11/16"
08532-18.0	18.0 – 17.5mm	45/64"
08532-18.5	18.5 – 18.0mm	23/32"
08532-19.0	19.0 – 18.5mm	3/4"
08532-19.5	19.5 – 19.0mm	49/64"
08532-20.0	20.0 – 19.5mm	25/32"

Black Gold ER Coolant Rings



Turn your collet chuck into a CoolBLAST holder

Use ER Coolant Rings without "o" ring for CoolBLAST coolant application.



Use ER Coolant Rings with "o" ring for coolant-thru tool.

ER coolant rings are great for unattended operation - there are no rubber seals to blow out under high pressure.

Cost Study Over 4 Year Period

	ER32 Coolant Collet	ER32 Coolant Ring System
Cost of 320 collets	\$16,000.00	\$8,640.00
Cost of 20 nuts	\$ 0.00 (come with holders)	\$1,300.00 (includes rings)
Total 4 year cost	\$16,000.00	\$9,940.00

\$6,060.00 savings

Figures based on 20 toolholders, allowing 4 collets a year for each toolholder for a total of 320 collets, plus one nut for each toolholder over the four year period.

Black Gold ER40 Coolant Rings

Part No.	Shank mm	Shank inch	Part No.	Shank mm	Shank inch
08540-03.5	3.5 – 3.0mm	1/8"	08540-11.0	11.0 – 10.5mm	27/64"
08540-04.0	4.0 – 3.5mm	5/32"	08540-11.5	11.5 – 11.0mm	7/16"
08540-04.5	4.5 – 4.0mm	11/64"	08540-12.0	12.0 – 11.5mm	15/32"
08540-05.0	5.0 – 4.5mm	3/16"	08540-12.5	12.5 – 12.0mm	31/64"
08540-05.5	5.5 – 5.0mm	13/64"	08540-13.0	13.0 – 12.5mm	1/2"
08540-06.0	6.0 – 5.5mm	7/32"	08540-13.5	13.5 – 13.0mm	17/32"
08540-06.5	6.5 – 6.0mm	1/4"	08540-14.0	14.0 – 13.5mm	35/64"
08540-07.0	7.0 – 6.5mm	17/64"	08540-14.5	14.5 – 14.0mm	9/16"
08540-07.5	7.5 – 7.0mm	9/32"	08540-15.0	15.0 – 14.5mm	37/64"
08540-08.0	8.0 – 7.5mm	5/16"	08540-15.5	15.5 – 15.0mm	19/32"
08540-08.5	8.5 – 8.0mm	21/64"	08540-16.0	16.0 – 15.5mm	5/8"
08540-09.0	9.0 – 8.5mm	11/32"	08540-16.5	16.5 – 16.0mm	41/64"
08540-09.5	9.5 – 9.0mm	3/8"	08540-17.0	17.0 – 16.5mm	21/32"
08540-10.0	10.0 – 9.5mm	25/64"	08540-17.5	17.5 – 17.0mm	11/16"
08540-10.5	10.5 – 10.0mm	13/32"	08540-18.0	18.0 – 17.5mm	45/64"
			08540-18.5	18.5 – 18.0mm	23/32"

ER Coolant Ring Sets

Part No.	Description
08516-14(SET)	14 piece ER16 coolant ring set
08520-20(SET)	20 piece ER20 coolant ring set
08525-26(SET)	26 piece ER25 coolant ring set
08532-34(SET)	34 piece ER32 coolant ring set
08540-46(SET)	46 piece ER40 coolant ring set

Part No.	Shank mm	Shank inch
08540-19.0	19.0 – 18.5mm	3/4"
08540-19.5	19.5 – 19.0mm	49/64"
08540-20.0	20.0 – 19.5mm	25/32"
08540-20.5	20.5 – 20.0mm	51/64"
08540-21.0	21.0 – 20.5mm	13/16"
08540-21.5	21.5 – 21.0mm	27/32"
08540-22.0	22.0 – 21.5mm	55/64"
08540-22.5	22.5 – 22.0mm	7/8"
08540-23.0	23.0 – 22.5mm	29/32"
08540-23.5	23.5 – 23.0mm	59/64"
08540-24.0	24.0 – 23.5mm	15/16"
08540-24.5	24.5 – 24.0mm	61/64"
08540-25.0	25.0 – 24.5mm	31/32"
08540-25.5	25.5 – 25.0mm	1.0"
08540-26.0	26.0 – 25.5mm	1 1/64"



All Techniks products are backed by our 100% satisfaction guarantee!

Precision TG75 Collets and PowerCOAT Nut



Features

- .0004" T.I.R.
- Precision ground & hand inspected
- Clamping range: 1/64"



Dimensions

Series	L	A
TG75	1.844"	1.062"

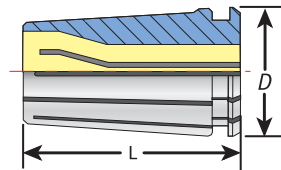

TG75 Sets

Part No.	Pieces	ID Sizes
04008-43S	43	1/8" - 3/4" by 64ths
04008-22S	22	1/8" - 3/4" by 32nds
04008-11S	11	1/8" - 3/4" by 16ths

TG75 Collets

Part No.	Shank	Part No.	Shank	Part No.	Shank	Part No.	Shank
04008-3/32	3/32"	04008-17/64	17/64"	04008-7/16	7/16"	04008-39/64	39/64"
04008-7/64	7/64"	04008-9/32	9/32"	04008-29/64	29/64"	04008-5/8	5/8"
04008-1/8	1/8"	04008-19/64	19/64"	04008-15/32	15/32"	04008-41/64	41/64"
04008-9/64	9/64"	04008-5/16	5/16"	04008-31/64	31/64"	04008-21/32	21/32"
04008-5/32	5/32"	04008-21/64	21/64"	04008-1/2	1/2"	04008-43/64	43/64"
04008-11/64	11/64"	04008-11/32	11/32"	04008-33/64	33/64"	04008-11/16	11/16"
04008-3/16	3/16"	04008-23/64	23/64"	04008-17/32	17/32"	04008-45/64	45/64"
04008-13/64	13/64"	04008-3/8	3/8"	04008-35/64	35/64"	04008-23/32	23/32"
04008-7/32	7/32"	04008-25/64	25/64"	04008-9/16	9/16"	04008-47/64	47/64"
04008-15/64	15/64"	04008-13/32	13/32"	04008-37/64	37/64"	04008-3/4	3/4"
04008-1/4	1/4"	04008-27/64	27/64"	04008-19/32	19/32"		



Features

- Increases holding power by 75%
- Balanced to 25,000 RPM
- Better rigidity and less T.I.R. (runout)

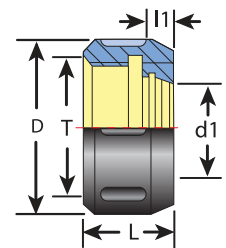

TG75 PowerCOAT Collet Nut

Part No.	Description	D	d1	T	I1	L	Wrench	Torque
84012	TG75 Collet Nut	1.88"	-	1 1/2 - 12"	0.32"	0.94"	04616	90 ft/lb

Precision TG100 Collets and PowerCOAT Nut



Features

- .0004" T.I.R.
- Precision ground & hand inspected
- Clamping range: 1/64"
- Metric sizes in stock



Dimensions

Series	L	A
TG100	2.375"	1.379"

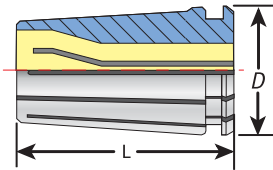

TG100 Sets

Part No.	Pcs.	ID Sizes
04010-59S	59	3/32 - 1" by 64ths
04010-41S	41	3/8 - 1" by 64ths
04010-30S	30	3/32 - 1" by 32nds
04010-21S	21	3/8 - 1" by 32nds
04010-15S	15	1/8 - 1" by 16ths

TG100 Collets

Part No.	Shank	Part No.	Shank	Part No.	Shank	Part No.	Shank
04010-3/32	3/32"	04010-21/64	21/64"	04010-9/16	9/16"	04010-51/64	51/64"
04010-7/64	7/64"	04010-11/32	11/32"	04010-37/64	37/64"	04010-13/16	13/16"
04010-1/8	1/8"	04010-23/64	23/64"	04010-19/32	19/32"	04010-53/64	53/64"
04010-9/64	9/64"	04010-3/8	3/8"	04010-39/64	39/64"	04010-27/32	27/32"
04010-5/32	5/32"	04010-25/64	25/64"	04010-5/8	5/8"	04010-55/64	55/64"
04010-11/64	11/64"	04010-13/32	13/32"	04010-41/64	41/64"	04010-7/8	7/8"
04010-3/16	3/16"	04010-27/64	27/64"	04010-21/32	21/32"	04010-57/64	57/64"
04010-13/64	13/64"	04010-7/16	7/16"	04010-43/64	43/64"	04010-29/32	29/32"
04010-7/32	7/32"	04010-29/64	29/64"	04010-11/16	11/16"	04010-59/64	59/64"
04010-15/64	15/64"	04010-15/32	15/32"	04010-45/64	45/64"	04010-15/16	15/16"
04010-1/4	1/4"	04010-31/64	31/64"	04010-23/32	23/32"	04010-61/64	61/64"
04010-17/64	17/64"	04010-1/2	1/2"	04010-47/64	47/64"	04010-31/32	31/32"
04010-9/32	9/32"	04010-33/64	33/64"	04010-3/4	3/4"	04010-63/64	63/64"
04010-19/64	19/64"	04010-17/32	17/32"	04010-49/64	49/64"	04010-1	1.0"
04010-5/16	5/16"	04010-35/64	35/64"	04010-25/32	25/32"		



Features

- Increases holding power by 75%
- Balanced to 25,000 RPM
- Better rigidity and less T.I.R. (runout) increase cutting tool life

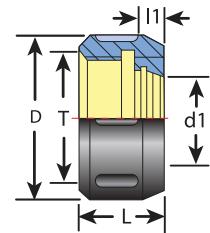

TG100 PowerCOAT Nuts

Part No.	Description	D	d1	T	I1	L	Spanner	Torque
28110	TG100 Collet Nut	2.35"	1.12"	1 7/8 - 12"	0.44"	1.18"	03691	90 ft/lb



Distributors - Call to register for our Distributors Webstore for full online access.

Precision TG100 Coolant Collets and PowerCOAT Nut



Features

- Up to 750 PSI coolant
- .0004" T.I.R.
- Clamping range: 1/64"

Use with TG PowerCOAT Nut



Nuts
pg. 62



Coolant
Rings
pg. 64



Retention
Knobs
pg. 200



Wrenches
pg. 204



Dimensions

Series	L	A
TG100	2.375"	1.379"

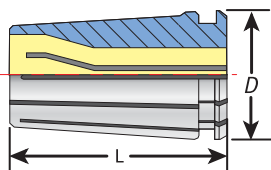

TG100 Coolant Collet Sets

Part No.	Pcs.	ID Sizes
84063-25(SET)	25	1/4" - 1.0" by 64ths

TG100 Coolant Collets

Part No.	Shank Size	Part No.	Shank Size	Part No.	Shank Size	Part No.	Shank Size
84063-1/4	1/4"	84063-7/16	7/16"	84063-5/8	5/8"	84063-13/16	13/16"
84063-9/32	9/32"	84063-15/32	15/32"	84063-21/32	21/32"	84063-27/32	27/32"
84063-5/16	5/16"	84063-1/2	1/2"	84063-11/16	11/16"	84063-7/8	7/8"
84063-11/32	11/32"	84063-17/32	17/32"	84063-23/32	23/32"	84063-29/32	29/32"
84063-3/8	3/8"	84063-9/16	9/16"	84063-3/4	3/4"	84063-15/16	15/16"
84063-13/32	13/32"	84063-19/32	19/32"	84063-25/32	25/32"	84063-31/32	31/32"
						84063-1	1.0"



Use with ER coolant rings
page 64.

Features

- Works with TG100 collets
- Up to 1,500 PSI coolant
- Increases holding power by 75%



ER32 coolant ring snaps into the
nut to seal the tool shank.

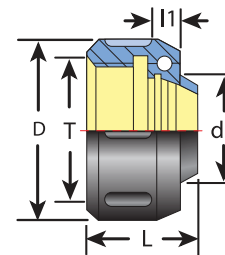

TG100 Coolant Nuts

Part No.	Description	D	d1	T	I1	L	Wrench	Torque
28210	TG100 Coolant Nut	2.35"	0.95"	1 7/8 - 12"	0.44"	1.41"	03691	90 ft/lb

Precision TG150 Collets and Collet Sets



Features

- .0004" T.I.R.
- Precision ground & hand inspected
- Clamping range: 1/64"



Dimensions

Series	L	A
TG150	3.0"	2.001"

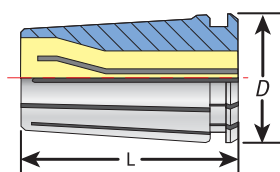

TG150 Collets

Part No.	Shank	Part No.	Shank	Part No.	Shank	Part No.	Shank
04011-17/64	17/64"	04011-23/32	23/32"	04011-31/32	31/32"	04011-1.1/4	1-1/4"
04011-3/8	38"	04011-47/64	47/64"	04011-63/64	63/64"	04011-1.17/64	1-17/64"
04011-7/32	7/32"	04011-3/4	3/4"	04011-1	1.0"	04011-1.9/32	1-9/32"
04011-1/2	1/2"	04011-49/64	49/64"	04011-1.1/64	1-1/64"	04011-1.19/64	1-19/64"
04011-33/64	33/64"	0410-20	20mm	04011-1.3/64	1-3/64"	04011-1.5/16	1-5/16"
04011-17/32	17/32"	04011-25/32	25/32"	04011-1.1/16	1-1/16"	04011-1.21/64	1-21/64"
04011-35/64	35/64"	04011-51/64	51/64"	04011-1.5/64	1-5/64"	04011-1.11/32	1-11/32"
04011-9/16	9/16"	04011-13/16	13/16"	04011-1.3/32	1-3/32"	04011-1.23/64	1-23/64"
04011-37/64	37/64"	04011-53/64	53/64"	04011-1.7/64	1-7/64"	04011-1.3/8	1-3/8"
04011-19/32	19/32"	04011-27/32	27/32"	04011-1.1/8	1-1/8"	04011-1.25/64	1-25/64"
04011-39/64	39/64"	04011-55/64	55/64"	04011-1.9/64	1-9/64"	04011-1.13/32	1-13/32"
04011-5/8	5/8"	04011-7/8	7/8"	04011-1.5/32	1-5/32"	04011-1.27/64	1-27/64"
04011-41/64	41/64"	04011-57/64	57/64"	04011-1.11/64	1-11/64"	04011-1.7/16	1-7/16"
04011-21/32	21/32"	04011-29/32	29/32"	04011-1.3/16	1-3/16"	04011-1.29/64	1-29/64"
04011-43/64	43/64"	04011-59/64	59/64"	04011-1.13/64	1-13/64"	04011-1.15/32	1-15/32"
04011-11/16	11/16"	04011-15/16	15/16"	04011-1.7/32	1-7/32"	04011-1.31/64	1-31/64"
04011-45/64	45/64"	04011-61/64	61/64"	04011-1.15/64	1-15/64"	04011-1.1/2	1-1/2"

TG150 Sets

Part No.	Pcs.	ID Sizes
04011-65S	65	1/2 - 1 1/2" by 64ths
04011-33S	33	1/2 - 1 1/2" by 32nds
04011-17S	17	1/2 - 1 1/2" by 16ths

SYOZ / EOC (DIN 6388) Perske Style Collets and Nuts



Features

- T.I.R. (runout) .0004"
- Collapse range: 1/64"
- Made from high-carbon steel

These collets and collet nuts conform to DIN 6388 standards. Snap collet into the nut before screwing the nut on to the spindle or holder.



Retention Knobs
pg. 200



Wrenches
pg. 204



Tightening Stands
pg. 206

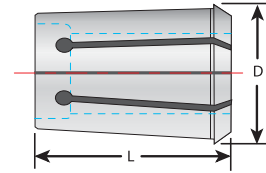

SYOZ20 / EOC 12 Collets

Part No.	Shank Size
83512-1/8	1/8"
83512-3/16	3/16"
83512-1/4	1/4"
83512-5/16	5/16"
83512-3/8	3/8"
83512-7/16	7/16"
83512-1/2	1/2"
83512-10	10mm

SYOZ25 Collets

Part No.	Shank Size
83868-1/8	1/8"
83868-3/16	3/16"
83868-1/4	1/4"
83868-5/16	5/16"
83868-3/8	3/8"
83868-7/16	7/16"
83868-1/2	1/2"
83868-9/16	9/16"
83868-5/8	5/8"
83868-3/4	3/4"
83868-7/8	7/8"
83868-1	1.0"
83868-10	10mm
83868-16	16mm
83868-20	20mm
83868-25	25mm

SYOC / EOC Collet Dimensions

Part No.	L	D
SYOZ20	34mm	20mm
SYOZ25	52mm	35mm
EOC 08	26mm	14.4mm
EOC16	40mm	25.5mm

EOC8 Collets

Part No.	Shank Size
83508-1/8	1/8"
83508-3/16	3/16"
83508-1/4	1/4"
03508-5/16	5/16"

SYOZ20/EOC 12 Collets

Various metric and inch sizes available from stock.

EOC16 Collets

Part No.	Shank Size
83531-1/8	1/8"
83531-3/16	3/16"
83531-1/4	1/4"
83531-5/16	5/16"
83531-3/8	3/8"
83531-7/16	7/16"
83531-1/2	1/2"
83531-9/16	9/16"
83531-5/8	5/8"
83531-10	10mm
83531-16	16mm



DIN 6388 Nuts and Wrenches

Part No.	Description	L	D	Wrench
83508-NUT	EOC08 nut	19	30	-
03636-NUT	EOC16 nut	24	43	03636
83634	SYOZ20/EOC 12 nut	20	35	22220
83634-L	SYOZ20/EOC 12 left-hand nut	20	35	22220
83632	SYOZ25 PowerCOAT nut	30	60	03691

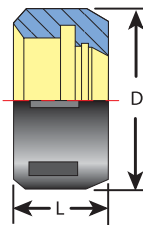

Precision Double Angle (DA) Collets



Features

- Collapse range: 1/64"
- Made from high-carbon steel

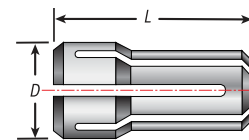

Double Angle Collet Sets

DA180	Description
01618-9S	9pc 1/4 - 3/4" by 16 ^{ths}
01618-17S	17pc 1/4 - 3/4" by 32 ^{nds}
01618-21S	21pc 1/8 - 3/4" by 32 ^{nds}
01618-33S	33pc 1/4 - 3/4" by 64 ^{ths}
01618-41S	41pc 1/8 - 3/4" by 64 ^{ths}

DA100	Description
01610-8S	8pc 1/8 - 9/16" by 16 ^{ths}
01610-15S	15pc 1/8 - 9/16" by 32 ^{nds}
01610-21S	21pc 1/4 - 9/16" by 64 ^{ths}
01610-29S	29pc 1/8 - 9/16" by 64 ^{ths}
01610-33S	33pc 1/16 - 9/16" by 64 ^{ths}

DA200	Description
01620-9S	9pc 1/8 - 3/8" by 32 ^{nds}
01620-17S	17pc 1/8 - 3/8" by 64 ^{ths}
01620-21S	21pc 1/16 - 3/8" by 64 ^{ths}

DA300	Description
01630-7S	7pc 1/16 - 1/4" by 32 ^{nds}
01630-14S	14pc 3/64 - 1/4" by 64 ^{ths}

Dimensions

Series	L	D
DA180	1.625"	1.035"
DA100	1.438"	0.769"
DA200	1.188"	0.531"
DA300	1.000"	0.375"

The last number in the part number indicates the number of collets in the set.

DA180 Collets	Size
01618-1/16	1/16"
01618-5/64	5/64"
01618-3/32	3/32"
01618-7/64	7/64"
01618-1/8	1/8"
01618-9/64	9/64"
01618-5/32	5/32"
01618-11/64	11/64"
01618-3/16	3/16"
01618-13/64	13/64"
01618-7/32	7/32"
01618-15/64	15/64"
01618-1/4	1/4"
01618-17/64	17/64"
01618-9/32	9/32"
01618-19/64	19/64"
01618-5/16	5/16"
01618-21/64	21/64"
01618-11/32	11/32"
01618-23/64	23/64"
01618-3/8	3/8"
01618-25/64	25/64"
01618-13/32	13/32"
01618-27/64	27/64"
01618-7/16	7/16"
01618-29/64	29/64"
01618-15/32	15/32"
01618-31/64	31/64"
01618-1/2	1/2"
01618-33/64	33/64"

DA100 Collets	Size
01610-17/32	17/32"
01610-35/64	35/64"
01610-9/16	9/16"
01610-37/64	37/64"
01610-19/32	19/32"
01610-39/64	39/64"
01610-5/8	5/8"
01610-41/64	41/64"
01610-21/32	21/32"
01610-43/64	43/64"
01610-11/16	11/16"
01610-45/64	45/64"
01610-23/32	23/32"
01610-47/64	47/64"
01610-3/4	3/4"
DA100 Collets	Size
01610-1/16	1/16"
01610-5/64	5/64"
01610-3/32	3/32"
01610-7/64	7/64"
01610-1/8	1/8"
01610-9/64	9/64"
01610-5/32	5/32"
01610-11/64	11/64"
01610-3/16	3/16"
01610-13/64	13/64"
01610-7/32	7/32"
01610-15/64	15/64"
01610-1/4	1/4"

DA100 Collets	Size
01610-17/64	17/64"
01610-9/32	9/32"
01610-19/64	19/64"
01610-5/16	5/16"
01610-21/64	21/64"
01610-11/32	11/32"
01610-23/64	23/64"
01610-3/8	3/8"
01610-25/64	25/64"
01610-13/32	13/32"
01610-27/64	27/64"
01610-7/16	7/16"
01610-29/64	29/64"
01610-15/32	15/32"
01610-31/64	31/64"
01610-1/2	1/2"
01610-33/64	33/64"
01610-17/32	17/32"
01610-35/64	35/64"
01610-9/16	9/16"
DA200 Collets	Size
01620-3/64	3/64"
01620-1/16	1/16"
01620-5/64	5/64"
01620-3/32	3/32"
01620-7/64	7/64"
01620-1/8	1/8"
01620-9/64	9/64"
01620-5/32	5/32"
01620-11/64	11/64"
01620-3/16	3/16"
01620-13/64	13/64"
01620-7/32	7/32"
01620-15/64	15/64"
01620-5/32	5/32"

DA200 Collets	Size
01620-11/64	11/64"
01620-3/16	3/16"
01620-13/64	13/64"
01620-7/32	7/32"
01620-15/64	15/64"
01620-1/4	1/4"
01620-17/64	17/64"
01620-9/32	9/32"
01620-19/64	19/64"
01620-5/16	5/16"
01620-21/64	21/64"
01620-11/32	11/32"
01620-23/64	23/64"
01620-3/8	3/8"
DA300 Collets	Size
01630-3/64	3/64"
01630-1/16	1/16"
01630-5/64	5/64"
01630-3/32	3/32"
01630-7/64	7/64"
01630-1/8	1/8"
01630-9/64	9/64"
01630-5/32	5/32"
01630-11/64	11/64"
01630-3/16	3/16"
01630-13/64	13/64"
01630-7/32	7/32"
01630-15/64	15/64"
01630-1/4	1/4"



Sign up to receive special offers at: www.techniksusa.com

CNC Collet Identification and Special Orders Guide

Use the guide below for selecting replacement collets. The best way to tell what type of collet you have is to measure the length of the collet. ER, TG, and SYOZ collets all have unique measurements. For best results always use a PowerCOAT nut tightened to proper specification using an accurate torque wrench.

ER Collet	L	D	Torque Spec
ER8	13mm (.51")	8.5mm (.33")	-
ER11	18mm (.708")	11.5mm (.45")	17 ft/lbs
ER16	27.5mm (1.08")	17mm (.67")	42 ft/lbs
ER20	31.5mm (1.24")	21mm (.83")	59 ft/lbs
ER25	34mm (1.34")	26mm (1.02")	77 ft/lbs
ER32	40mm (1.57")	33mm (1.3")	100 ft/lbs
ER40	46mm (1.81")	41mm (1.61")	119 ft/lbs
ER50	60 mm (2.36")	52mm (2.05")	-

TG Collet	L	D	Torque Spec
TG75	47mm (1.85")	27mm (1.06")	90 ft/lbs
TG100	60mm (2.36")	35mm (1.38")	90 ft/lbs
TG150	76mm (3")	51mm (2")	110 ft/lbs

SYOZ / EOC Collet	L	D
EOC8	26mm (1.026")	14.4mm (.567")
SYOZ20	34mm (1.34")	20mm (.78")
RDO 20	34mm (1.34")	20mm (.78")
407E	34mm (1.34")	20mm (.78")
EOC 12	34mm (1.34")	20mm (.78")
SYOZ25	52mm (2.06")	35mm (1.38")
RDO 35	52mm (2.06")	35mm (1.38")
462E / SYOZ25	52mm (2.06")	35mm (1.38")
EOC 32	60mm (2.36")	43.7mm (1.72")

DA Collet	L	D
DA180	1.625"	1.035"
DA100	1.438"	.769"
DA200	1.188"	.531"
DA300	1.000"	.375"

DNA Collet	L	D
DNA 11	16.9mm (0.67")	11.5mm (0.45")
DNA 16	24mm (0.94")	17mm (0.67")
DNA 20	30.42mm (1.20")	21.10mm (0.83")
DNA 32	40mm (1.57")	33.25mm (1.31")

Special Order Collets Dimensions

Length _____ Diameter _____ Other Markings _____

Length _____ Diameter _____ Other Markings _____

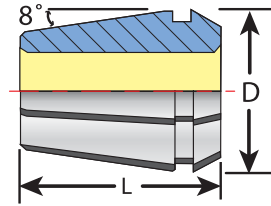

ER Collet Style

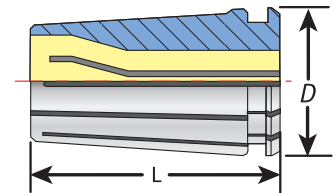

TG Collet Style

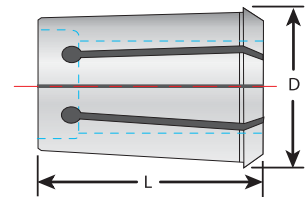

SYOZ Collet Style

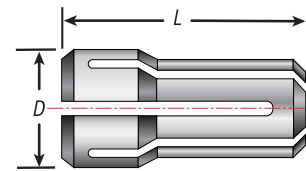

DA Collet Style

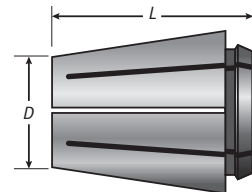

DNA Collet Style